

JBC

www.jbctools.com

INSTRUCTION MANUAL



CL6217

Metal Brush for Compact
Stations & Manual Tip Cleaner

This manual corresponds to the following reference:

CL6217

Packing List

The following items are included:



Metal Brush 1 unit



Manual 1 unit
Ref. 0027085

Metal Brush replacement in Compact Stations *

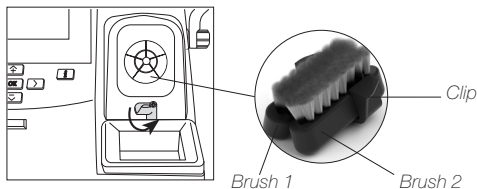

*** Note:** To join 2 brushes the connection clip is needed. Ref. CL 6217 does not include any clip. Reuse the clip of your worn brushes.
Instead, the replacement Ref. CL6220 carries the clip built.

The connection clip is not needed when CL6217 is used as a replacement for CP-A and CF-A.

Metal Brush replacement in CL8499 *

1. Unlock

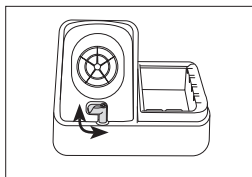

2. Remove and replace

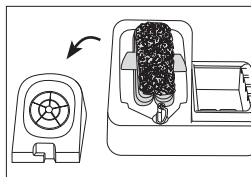

Optional Cleaning Products



Inox Wool
Ref. CL6205



Brushes
Ref. CL6220



Tip Tinner
Ref. TT-A



Brass Wool
Ref. CL6210



Sponge
Ref. S0354

Specifications

CL6217

Metal Brush for Compact Stations & Manual Tip Cleaner

Ref.: **CL6217**

- Total Net Weight: 16.9 gr / 0.037 lb
- Total Package Dimensions: 90 x 55 x 40 mm
(L x W x H) 3.54 x 2.17 x 1.57 in
- Total Package Weight: 18.1 gr / 0.04 lb

Complies with CE standards.

JBC

Warranty

JBC's 2 year warranty covers this equipment against all manufacturing defects, including the replacement of defective parts and labour.

Warranty does not cover product wear or misuse.

In order for the warranty to be valid, equipment must be returned, postage paid, to the dealer where it was purchased.



This product should not be thrown in the garbage.

In accordance with the European directive 2012/19/EU, electronic equipment at the end of its life must be collected and returned to an authorized recycling facility.



www.jbctools.com