



TESE

Precision Hot Air Station

This Plug & Play Guide corresponds to the following references:

Ref.

TESE-9B (100 V)
TESE-1B (120 V)
TESE-2B (230 V)

Station

More Information at the
product web page



Video Guide

Watch the
product video



Packing List

The following items are included according purchased station reference:

 	 	 
JTSE Hot Air Control Unit 1 unit Ref. JTSE-9UA (100 V) Ref. JTSE-1UA (120 V) Ref. JTSE-2UA (230 V)	TES Stand 1 unit Ref. TE-SF	TET Precision Heater Hose Set 1 unit Ref. TE-TB (230 V / 120 V)
 	 	 
TN9080 TET Straight Nozzle Ø 5 mm 1 unit Ref. TN9080	TN9208 TET Straight Nozzle Ø 4 mm 1 unit Ref. TN9208	TN9209 TET Straight Nozzle Ø 3 mm 1 unit Ref. TN9209
 	 	 
PH217 Kapton Tape 1 unit Ref. PH217	PH218 Thermocouple Type K1 unit Ref. PH218	ESHT Magazine for Protectors & Extractors 1 unit Ref. ESHT-A

Installation

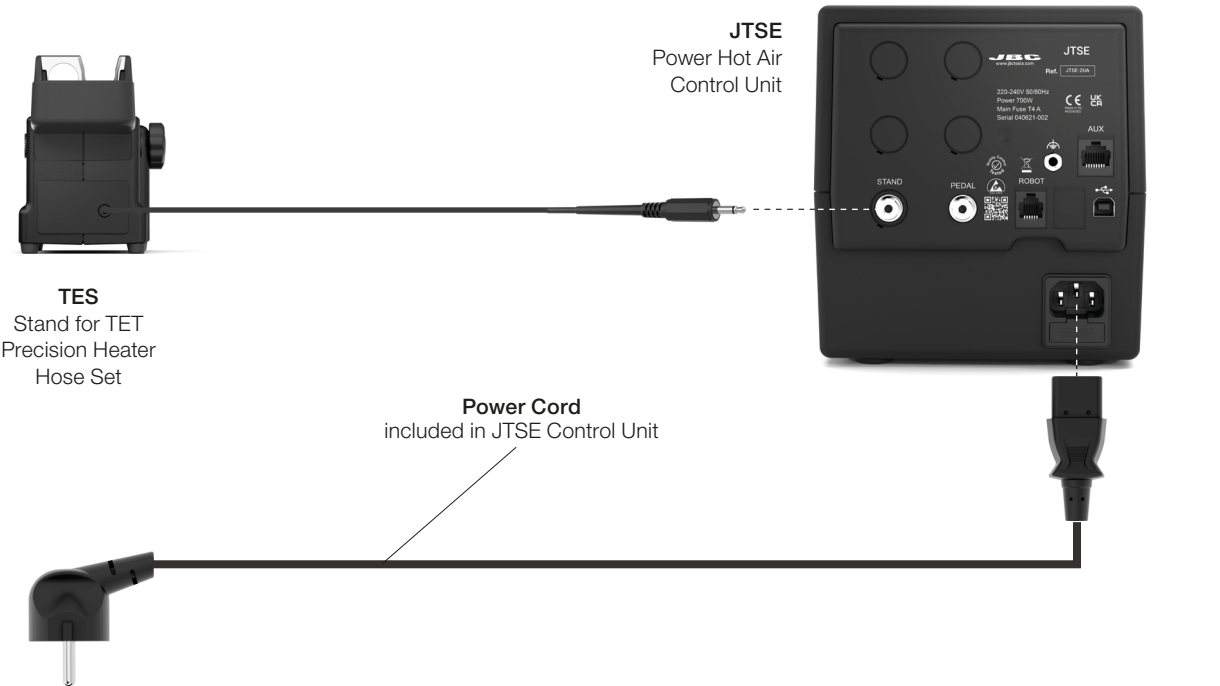

Installation

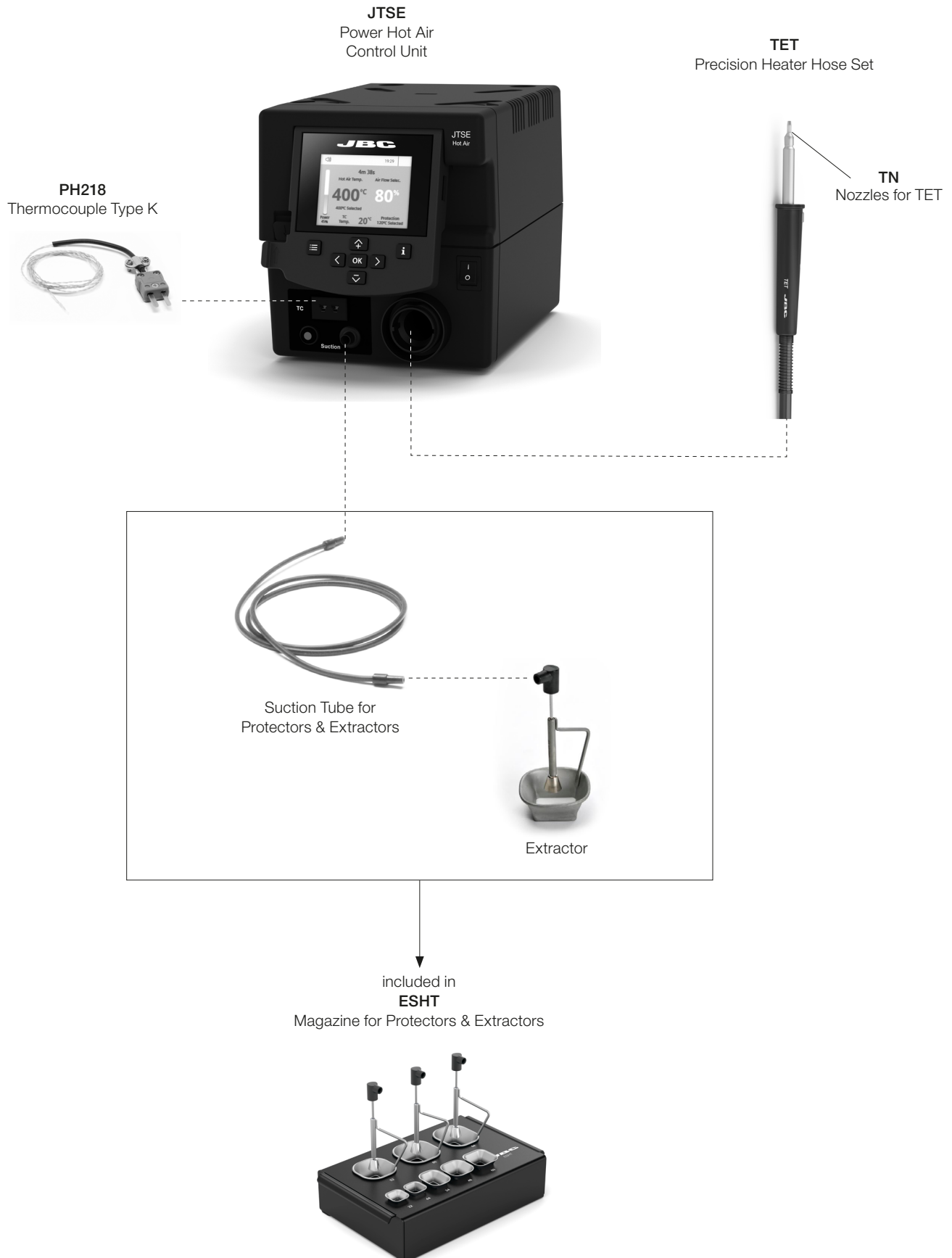

Specifications

TESE

Precision Hot Air Station

Ref. **TESE-9B** (100 V)

Ref. **TESE-1B** (120 V)

Ref. **TESE-2B** (230 V)

- Package Dimensions / Weight:
(L x H x W)

474 x 368 x 195 mm / 5.68 kg

18.7 x 14.5 x 7.68 in / 12.54 lb

Complies with CE standards.
ESD safe.

JBC

Warranty

Information regarding the warranty of each product can be found on the final page of its instruction manual.



This product should not be thrown in the garbage.

In accordance with the European directive 2012/19/EU, electronic equipment at the end of its life must be collected and returned to an authorized recycling facility.