

# JBC

[www.jbctools.com](http://www.jbctools.com)

Product  
website



## INSTRUCTION MANUAL

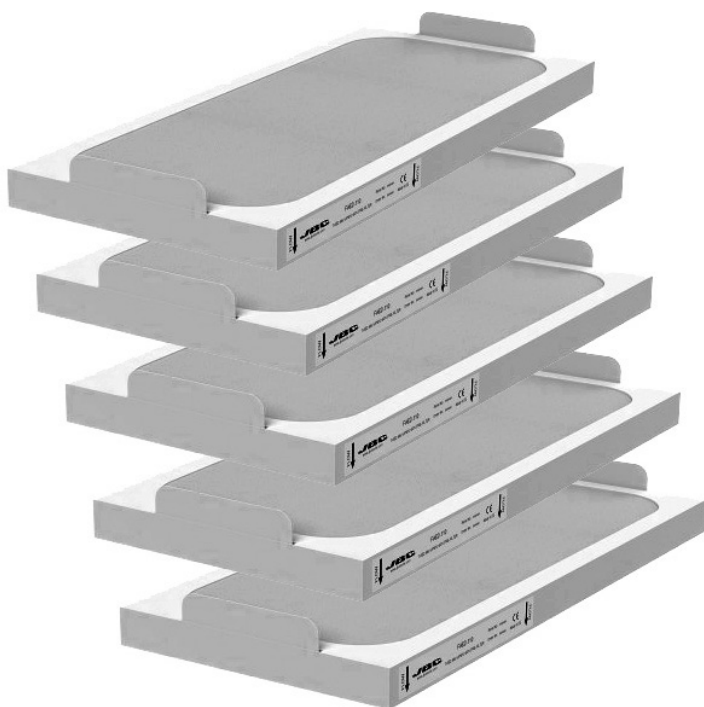

# FAE2110

Pre-Filter for FAE2

This manual corresponds to the following reference:

**FAE2-110**

## Packing List

The following items are included:



**Pre-Filter for FAE1** ..... 5 units

**Manual** ..... 1 unit  
Ref. 0020108

## Features

This Pre-filters are used in FAE2\* fume extractors and retain large solid particles in order to protect HEPA filter and extend its lifetime.

The indicator LED and the display of FAE2 show the filter status.



Follow the indications described in section “Maintenance” to replace the filters when they are worn.

*\*not included, sold separately.*

## Control Process

### Filter Menu

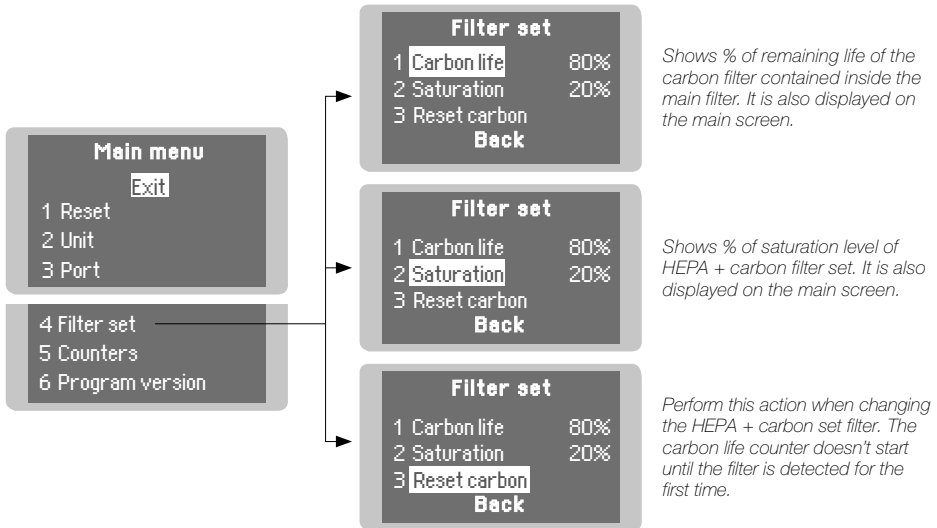

### Warning & Errors

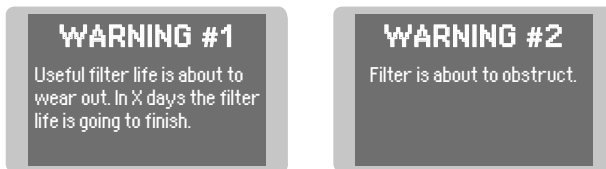

The unit notifies when filters need maintenance.

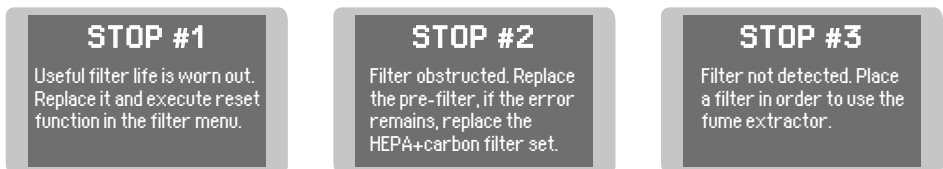

The unit stops working when filters have to be replaced.

## Maintenance - Filter Replacement

- The fume extractor unit indicates by means of the display and the indicator LED (3) that the filters need to be replaced.

- To replace the filters remove the cover (1) by opening the quick release levers (2), located on both sides of the casing.

- If the indicator LED (3) remains in red after replacing the pre-filter (4), it means that the main filter (5) is saturated and must also be replaced.

- After replacing the main filter (5), the carbon filter counter must be reset (Main Menu: *Filter Set > Reset Carbon*).

- The service life of the main filter is a maximum of 1 year after opening its packaging.

- If the filter is changed while the fume extractor is switched on, the fume extractor unit automatically starts the filter detection process and activates the aspiration for a few seconds.

- If the display shows an error when the equipment is switched on, the cover and casing connectors are probably dirty (6) and making false contact. Remove the cover and clean both connectors carefully, using a soft plastic brush.



**Important:** Before using, unseal the new filter and remove the bottom protection of the compact filter.

Cover

①

Pre-Filter

④

⑤

Main Filter  
(includes carbon  
+ HEPA filter)

②

②

Quick Release  
Lever

Display and filter saturation  
indicator LED

③

Casing

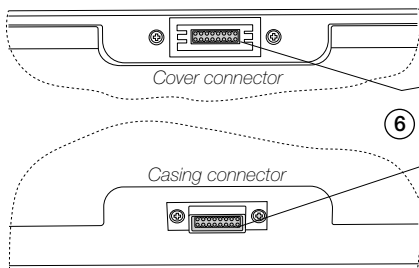

### Note:

The cover has a given position. Make sure the cover connector mate with the casing connector.

## Maintenance - Filter Positioning

- Inserting the new pre-filter bear in mind the arrows printed on the lateral side must be showing downwards, direction main filter,

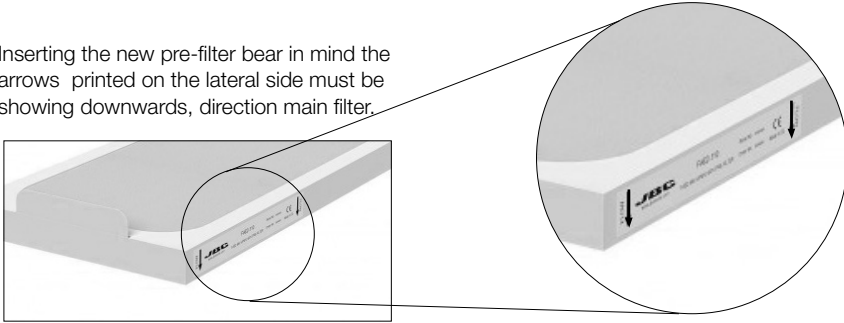

## Safety



**It is imperative to follow safety guidelines to prevent electric shock, injury, fire or explosion.**

- The equipment is only designed to filtrate the fumes generated by soldering.
- Do not use the units for the filtration of combustible, explosive or corrosive gases. Incorrect use may cause fire.
- Maintenance must not be carried out by children unless supervised.
- Keep your workplace clean and tidy. Wear appropriate protective mask, glasses and gloves when handling dirt filter or pre-filter.
- Saturated filters can not be cleaned and reused.
- Avoid blowing the filter or the dirty parts of the equipment, if necessary it is advisable to vacuum.
- Avoid losing particles in the unit during handling of the filter.
- Treat the saturated filters as waste depending on the filtered contaminant and the applicable standards in each country.

European Waste Catalog classification:

15 02: Absorbents, filter materials, wiping cloths and protective clothing.

15 02 02: Absorbents, filter materials (including oil filters not otherwise specified, wiping cloths, protective clothing contaminated by dangerous substances.

15 02 03: Absorbents, filter materials, wiping cloths and protective clothing other than those mentioned in 15 02 02.

- In case of not complying with the filter change recommendations, the maximum particle and gas concentrations established in each country could be exceeded.

## Notes

This image shows a blank sheet of white paper with horizontal ruling lines. The lines are evenly spaced and run across the width of the page. There are no margins, text, or other markings on the paper.

## Notes

This image shows a single sheet of white paper with horizontal blue or grey ruling lines. The lines are evenly spaced and run across the width of the page. There are approximately 20 lines visible. The paper has a slight shadow on the right side, suggesting it's resting on a surface. There is no handwriting or other markings on the paper.

# Specifications

## FAE2110

### Pre-Filter for FAE2

Ref. FAE2-110

- |   |  |
|---|--|
| - Pre-Filter:                                 | Medium dust filter M5 (EN 779)                           |
| - Filter Weight (1 unit):                     | 122 gr / 0.02 lb   |
| - Filter Dimensions (1 unit):                 | 445 x 200 x 25 mm / 17.52 x 7.87 x 0.98 in               |
| - Total Net Weight:                           | 610 g / 1.34 lb  |
| - Package Dimensions / Weight:<br>(L x H x W) | 460 x 217 x 144 / 920 g<br>18.11 x 8.54 x 5.67 / 2.03 lb |

Complies with CE standards.

# JBC

## Warranty

JBC's 2 year warranty covers this equipment against all manufacturing defects, including the replacement of defective parts and labor.

Warranty does not cover product wear or misuse.

In order for the warranty to be valid, equipment must be returned, postage paid, to the dealer where it was purchased.



This product should not be thrown in the garbage.

In accordance with the European directive 2012/19/EU, electronic equipment at the end of its life must be collected and returned to an authorized recycling facility.

