

# **JBC**

[www.jbctools.com](http://www.jbctools.com)

## **INSTRUCTION MANUAL**



**F3435, F3449, F3450, F6457**

Fume Extractor for T210,  
T245 & T470

This manual corresponds to the following references:

**F3450** for T210, tube ø 4 mm

**F3449** for T245, tube ø 4 mm

**F3435** for T245, tube ø 6 mm

**F6457** for T470, tube ø 6 mm

## Packing list

The following items are included:



**Fume Extractor** ..... 1 unit

**Cleaning Brush** ..... 1 unit

*According to purchased reference.*



**Manual** ..... 1 unit

Ref. 0031932

## Features

Fume Extractors for Tools are used to extract the smoke produced during soldering near the soldering tip. An extraction pump with filter is required.

According to purchased reference, they are designed to be used with JBC soldering tools: T245, T210 and T470 Handles.

Depending on the reference, they come with different tube diameters:

## Compatibility

Fume Extractor	F3435	F3449	F3450	F6457
Ø Tube (mm)	6	4	4	6
T245 Handles	✓	✓		
T470 Handles				✓
T210 Handles			✓	

# Assembly

## For T210 Handles \*

Place the clamp directly on the handle (1) and slide it forward or backward (2) until the opening of the extractor nozzle is placed near the tip of the cartridge (3).

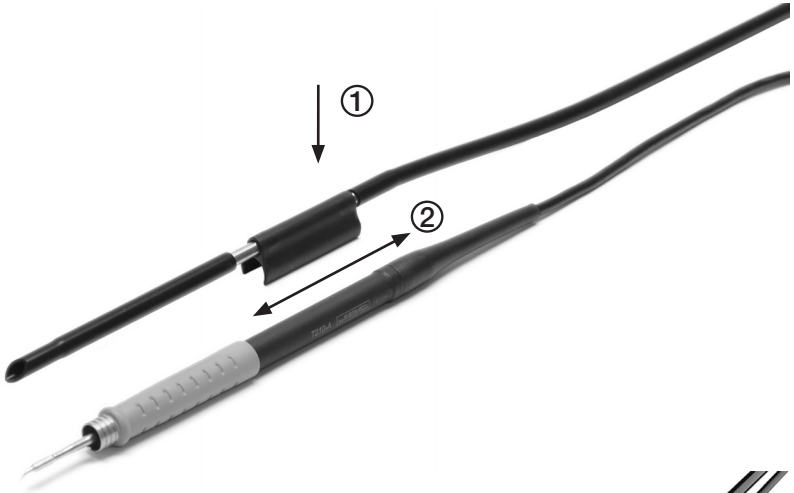

Adjust the position of the extractor to get the nozzle opening near the cartridge tip.

\* not included, sold separately.

### For T245 & T470 Handles \*

Thread the cable into the clamp (1) and slide the clamp onto the handle (2) until the opening of the extractor nozzle is placed near the tip of the cartridge (3).

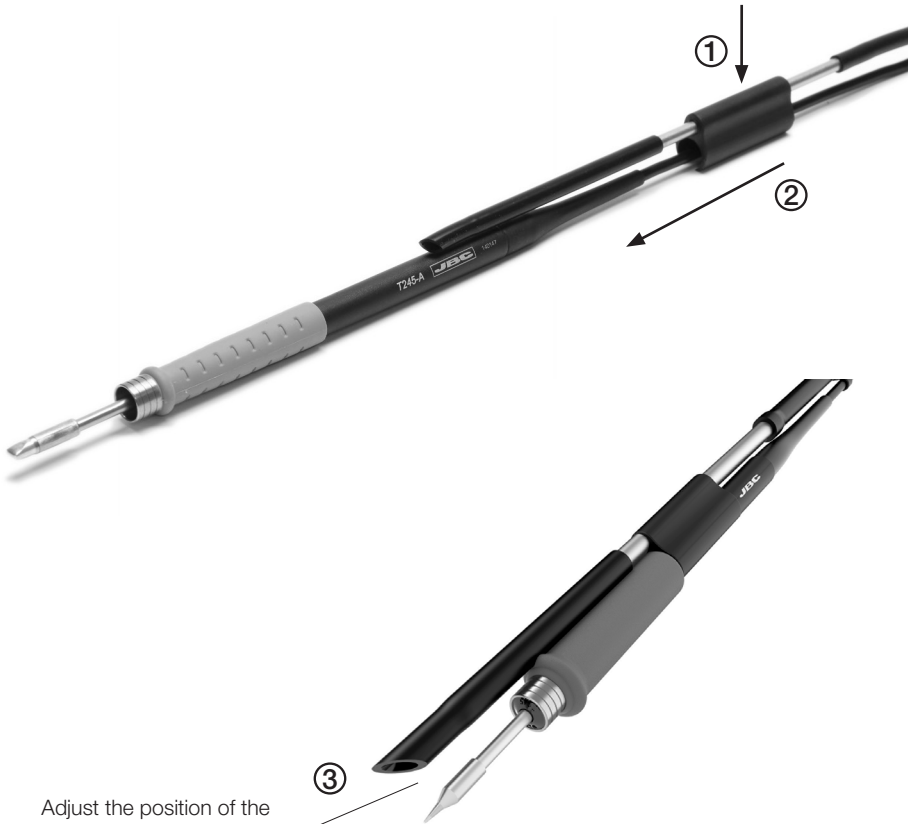

Adjust the position of the extractor to get the nozzle opening near the cartridge tip.

*\* not included, sold separately.*



## Specifications

### **F3450, F3435, F3449, F6457**

#### **Fume Extractors for T210, T245 & T470**

Ref.: **F3450, F3435, F3449, F6457**

- Package Dimensions: 245 x 185 x 45 mm / 9.65 x 7.28 x 1.77 in  
(L x W x H)

#### **F3450** for T210

- Tube Length: 2.1 m / 82.68 in  
- Total Net Weight: 54 g / 0.120 lb  
- Package Weight: 124 g / 0.273 lb

#### **F3435** for T245

- Tube Length: 2.1 m / 82.68 in  
- Total Net Weight: 97 g / 0.214 lb  
- Package Dimensions / Weight: 167 g / 0.381 lb

#### **F3449** for T245

- Tube Length: 2.1 m / 82.68 in  
- Total Net Weight: 59 g / 0.130 lb  
- Package Dimensions / Weight: 127 g / 0.280 lb

#### **F6457** for T470

- Tube Length: 3.6 m / 141.73 in  
- Total Net Weight: 138 g / 0.304 lb  
- Package Dimensions / Weight: 206 g / 0.454 lb

Complies with CE standards.

# JBC

---

## Warranty

JBC's 2 year warranty covers this equipment against all manufacturing defects, including the replacement of defective parts and labour.

Warranty does not cover product wear or misuse.

In order for the warranty to be valid, equipment must be returned, postage paid, to the dealer where it was purchased.

---



This product should not be thrown in the garbage.

In accordance with the European directive 2012/19/EU, electronic equipment at the end of its life must be collected and returned to an authorized recycling facility.



[www.jbctools.com](http://www.jbctools.com)