

JBC

www.jbctools.com

Product
website



INSTRUCTION MANUAL



FAE020

Flexible Arm

This manual corresponds to the following reference:

FAE020

- Total length (tube compressed): 0.92m / 36.22 in
- Max. operating distance: 0.70 m / 27.56 in (see page 4)

Packing List

The following items are included:



Flexible Arm 1 unit

Screws 3 units
DIN7982 - ø3.5x25 - black burnished
Ref. 0019142



Manual 1 unit
Ref. 0019181

Assembly Example

FAE 020

Flexible Arm ø 50 mm

Take in mind the installation
dimensions (see page 5 below)

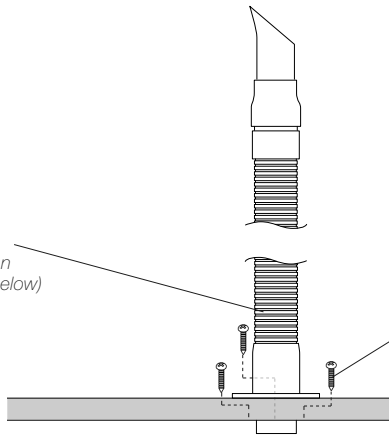

Fix the flange on your
workbench with the supplied
screws (more information at
page 6)

FAE010

Flexible Hose ø 50 mm

Total length: ~1.6 m / ~63 in

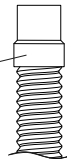

Connect the flexible Hose
to the flexible Arm

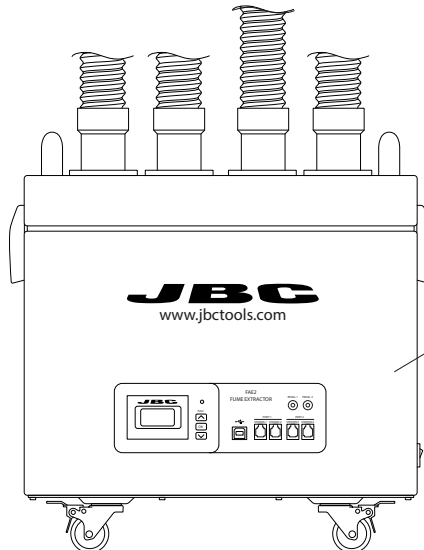

FAE2
Fume Extractor

How to use

Arm Installation

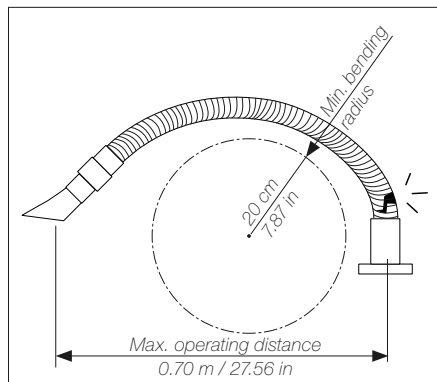
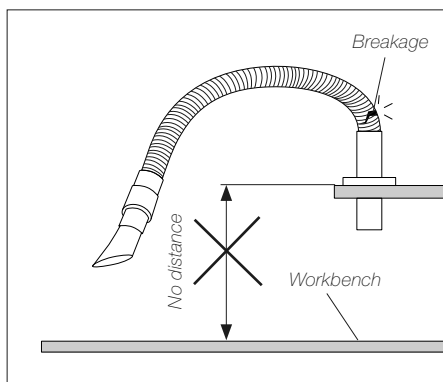

Do not install the flexible arm on shelves or higher levels than the work bench. Forced bending radii can cause the arm to break.

To avoid breaking the hose, do not extend the arm more than 100 cm / 39.37 in from the center of its base and do not go below the minimum bend radius of 20 cm / 7.87 in.

Arm Positioning

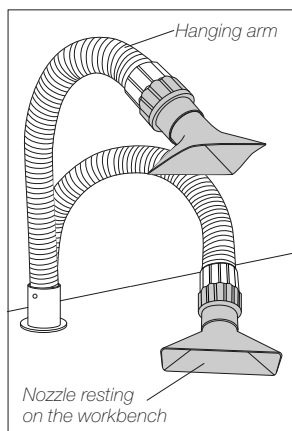

The arm can be used in an upright position with the nozzle hanging over the workplace or with the nozzle resting on the workbench.

Hose Compression

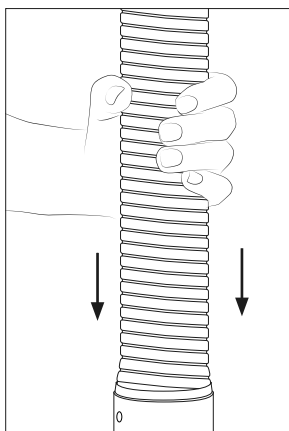

In case of breakage, the hose can be reconnected. To reconnect the hose, align the two parts and push them firmly until they interlock.

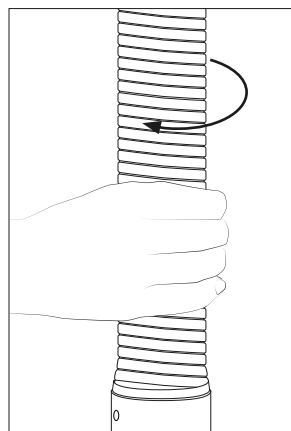

If the hose loses firmness, it must be recompressed. To increase compression, turn the hose slightly clockwise. After the hose is compressed, readjust its position.

Nozzle Replacement

The nozzle is attached to the hose by means of a bayonet lock, which makes it easy to replace the nozzles.

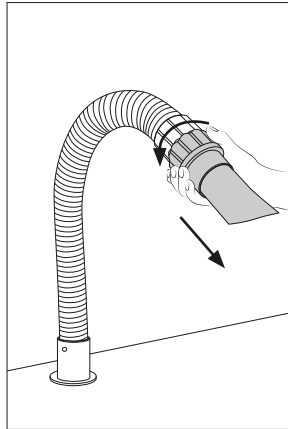

To disassemble the nozzle, hold the hose fitting with one hand. With the other hand, turn the nozzle counter-clockwise and pull it out.

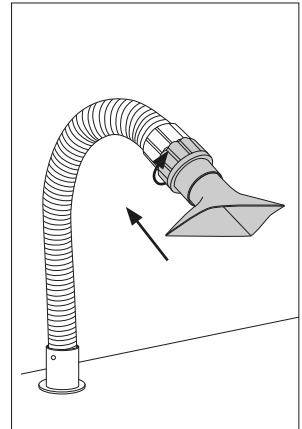

To install a new nozzle, turn the nozzle bayonet clockwise to lock it in place.

Accessories

The supplied nozzle can be replaced by one of the following nozzles. Choose the one that best suits your needs.

Note: FAE020 is **only compatible** with nozzles FAE080, FAE081, FAE082 and FAE083. It is **not compatible** with nozzles FAE090, FAE091, FAE092 and FAE093.



FAE080
Rectangular Nozzle for FAE
Approx. 170 x 90 mm /
6.69 x 3.54 in

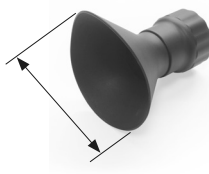

FAE081
Round Nozzle for FAE
Approx. \varnothing 120 mm /
 \varnothing 4.72 in

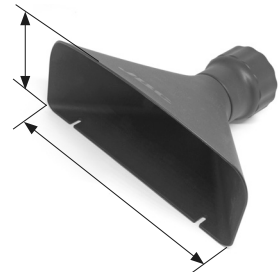

FAE082
Large Rectangular Nozzle for FAE
Approx. 227 x 107 mm /
8.94 x 4.21 in

Dimensions Scheme for FAE020 Fixing

To assemble the flexible arm FAE020 (Ø50) for the first time follow these instructions:

- First make the large central hole in your workbench as shown in the drawing below.
- Place the fitting of the flange in the opening and mark the points for the three pilot holes.
- Remove the arm and drill the three holes at the marked spots. The hole diameter can be found in the dimension scheme:

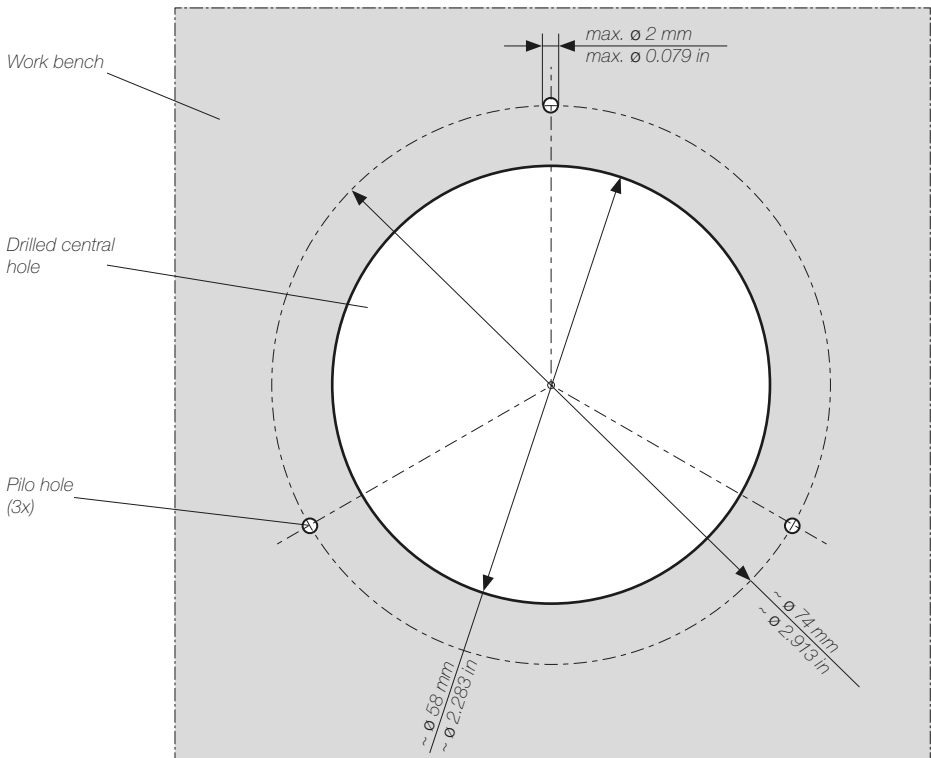

- Return the flexible to the center hole and align the holes in the flange with the pilot holes drilled in the workbench. Screw the arm to the bench using the three screws supplied with the arm.

Notes

This image shows a single sheet of white paper with horizontal blue or grey ruling lines. The lines are evenly spaced and run across the width of the page. There are approximately 20 lines visible. The paper has a slight shadow on its right side, suggesting it's resting on a surface.

Specifications

FAE020

Flexible Arm

Ref. **FAE020**

- | | |
|-----------------------------------|----------------------------------|
| - Inner tube diameter: | ø50 mm / ø1.97 in |
| - Total length (tube compressed): | 0.92 m / 36.22 in |
| - Max. operating distance: | 0.70 m / 27.56 in (see page 4) |
| - Total net weight: | 1.76 kg / 3.88 lb |
| - Package dimensions / weight: | 1050 x 170 x 120 mm / 2.5 kg |
| (L x W x H) | 41.34 x 6.69 x 4.72 in / 5.51 lb |

Complies with CE standards.
ESD safe.

JBC

Warranty

JBC's 2 year warranty covers this equipment against all manufacturing defects, including the replacement of defective parts and labor.

Warranty does not cover product wear or misuse.

In order for the warranty to be valid, equipment must be returned, postage paid, to the dealer where it was purchased.



This product should not be thrown in the garbage.

In accordance with the European directive 2012/19/EU, electronic equipment at the end of its life must be collected and returned to an authorized recycling facility.

