

# **JBC**

[www.jbctools.com](http://www.jbctools.com)

## **INSTRUCTION MANUAL**



## **Fume Inlet Duct for Compact Stations**

Ref. FAE060

# Packing List

The following items should be included:

**Fume Inlet Duct for Compact Stations** ..... 1 unit  
Ref. FAE060

**Manual** ..... 1 unit  
Ref. 0019113



# Connection



**1** Turn the knob counterclockwise until it loosens.



**2** Insert the fume inlet duct for compact stations between the knob and the tool holder.

## Connection



**3** Connect the fume inlet duct for compact stations to the accessory for stand aspiration (Ref. FAE030/FAE040).



**4** The system detects when the tool is returned to the station and the vent absorbs the fumes automatically.

## Maintenance

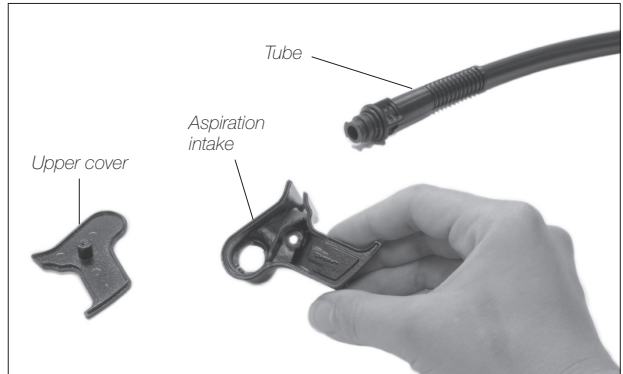
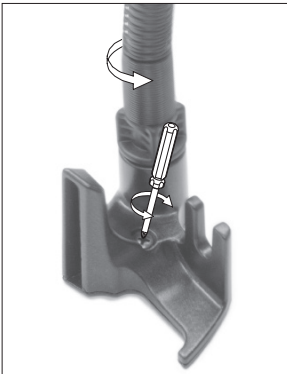

- Before carrying out maintenance, always allow the tool to cool.
- Remove the screw and loosen the upper cover.
- Clean the inside of the aspiration intake with a cleaning stick.
- To clean the tube, loosen it from the aspiration intake by turning it. Then shake the tube to remove the dirt.

# Specifications

- Weight: 170 gr (0.02 lb)
- Length: 107 cm (42.1 in)

Complies with CE standards.  
ESD protected.

# JBC

---

## Warranty

JBC's 2 year warranty covers this equipment against all manufacturing defects, including the replacement of defective parts and labour.

Warranty does not cover product wear or misuse.

In order for the warranty to be valid, equipment must be returned, postage paid, to the dealer where it was purchased.

**Register your warranty within 30 days of purchase in [www.jbctools.com/productregistration](http://www.jbctools.com/productregistration)**

---



This product should not be thrown in the garbage.

In accordance with the European directive 2002/96/EC, electronic equipment at the end of their life must be collected and returned to an authorized recycling facility.



Manual in other languages available on our website

**[www.jbctools.com](http://www.jbctools.com)**