

JBC

www.jbctools.com

Product
website



INSTRUCTION MANUAL



T210, T245, T470

Handles

This manual corresponds to the following references:

Precision Handles

- T210-A
- T210-PA
- T210-NA

Packing List

For refs. **T210-A/PA**



Handle 1 unit

According to purchased reference.

*Additionally, it includes
1x Sealing Plug, 1x Grip and
2x Fitters.*

For ref. **T210-NA**



Nitrogen Handle* ... 1 unit

*Additionally, it includes
1x Nozzle (ref. B6647).*

General Purpose Handles

- T245-A
- T245-GA
- T245-PA
- T245-NA

Packing List

For refs. **T245-A/GA/PA**



Handle 1 unit

*According to purchased reference.
Additionally, it includes 1x Sealing
Plug, 1x Grip and 2x Fitters.*

For ref. **T245-NA**



Nitrogen Handle* 1 unit

*Additionally, it includes 2x Nozzles
(refs. B7968 and B7244).*

Heavy Duty Handles

- T470-A
- T470-SA
- T470-ZA
- T470-FA
- T470-MC
- T470-NA

Packing List

For refs. **T470-A/SA/ZA/FA/MC**



Handle 1 unit

*According to purchased reference.
Additionally, it includes 1x Sealing
Plug.*

For ref. **T470-NA**



Nitrogen Handle* 1 unit

*Additionally, it includes 3x Nozzles
(refs. B6193, B6194 and B6195).*

Manual 1 unit
Ref. 0028966

* Cartridge not included, sold separately.

Features - T210 Precision Handles

T210 Handles are suitable for precision soldering jobs with medium power requirements. Due to their size, they are ideal for conventional or small SMD soldering jobs, even under a microscope.

They come with a soft foam grip to ensure a better handling of the tool and a greater comfort when working.

T210 Handles are supplied with a 1.5 m cable and work with C210 cartridges (*not included*).

T210 Precision Handle

Ref. T210-A



T210P Blue-Grip Precision Handle

Ref. T210-PA

T210P Handles come with a blue grip for easy differentiation from other handles, e.g. when leaded and unleaded solder wire are used.



T210N Nitrogen Precision Handle

Ref. T210-NA

T210N Handles are designed to create an oxygen-free atmosphere, thus ensuring higher quality soldering. They offer extra heat to the solder joint and help prevent oxidation.

Note: JBC's GN Nitrogen Generator Module or an external nitrogen feed is needed.



* For more information on grip replacement references, see page 9.

Features - T245 General Purpose Handles

T245 Handles are suitable for working with SMD components and for soldering jobs with high power requirements (e.g. ground plane soldering).

Some models come with soft foam grips to ensure a better handling of the tool and a greater comfort when working, while also providing thermal insulation.

T245 Handles are supplied with a 1.5 m cable and work with C245 Cartridges (*not included*).

T245 General Purpose Handle

Ref. T245-A

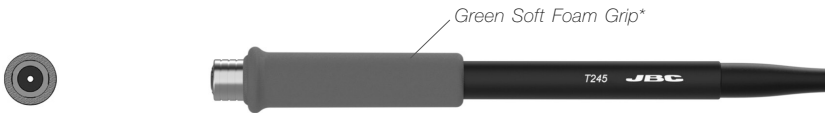

T245G General Purpose Handle with Reinforced Cable

Ref. T245-GA

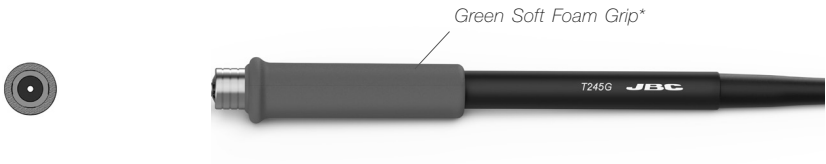

T245P Blue-Grip Handle

Ref. T245-PA

T245P Handles come with a blue grip for easy differentiation from other handles, e.g. when leaded and leadfree solder wire are used.

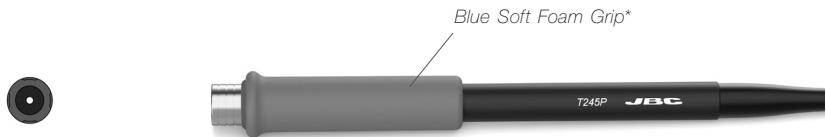

* For more information on grip replacement references, see page 9.

T245N Nitrogen General Purpose Handle

Ref. T245-NA

T245N Handles are designed to create an oxygen-free atmosphere, thus ensuring higher quality soldering. They offer extra heat to the solder joint and help prevent oxidation.

Note: JBC's GN Nitrogen Generator Module or an external nitrogen feed is needed.



Features - T470 Heavy Duty Handles

T470 Handles are suitable for intensive soldering jobs requiring high power delivery, such as power electronic component soldering, large coax cable soldering, metal sheet soldering, etc.

They are available with grips of several shapes and materials, as well as different cable lengths (see below).

T470 Handles feature a set screw to secure the cartridge within the handpiece, preventing its rotation.

T470 Heavy Duty Handle (1.5 m / 4.92 ft cable)

Ref. T470-A

T470S Heavy Duty Handle (3 m / 9.84 ft cable)

Ref. T470-SA

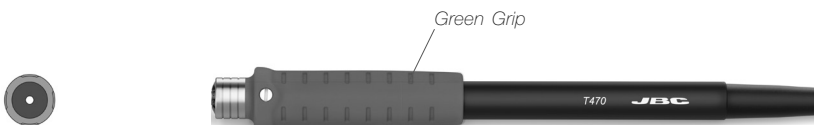

T470F Thermal Insulator Grip HD Handle (1.5 m / 4.92 ft cable)

Ref. T470-FA

T470M Thermal Insulator Grip HD Handle (3 m / 9.84 ft cable)

Ref. T470-MC

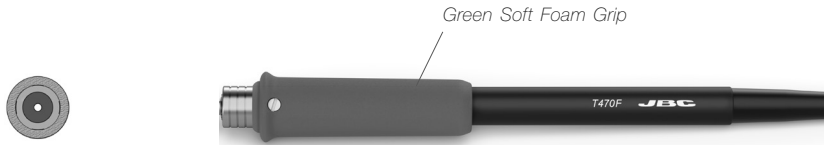

T470Z Tri-Lobed Grip HD Handle (1.5 m / 4.92 ft cable)

Ref. T470-ZA

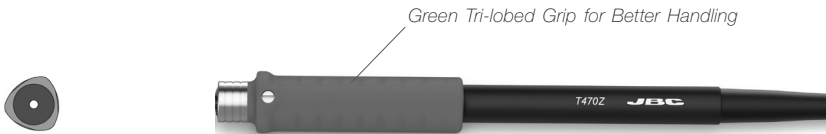

T470N Nitrogen HD Handle (1.5 m / 4.92 ft cable)

Ref. T470-NA

T470N Handles are designed to create an oxygen-free atmosphere, thus ensuring higher quality soldering. They offer extra heat to the solder joint and help prevent oxidation.

Note: JBC's GN Nitrogen Generator Module or an external nitrogen feed is needed.



Changing Cartridges - T210 and T245 Handles

JBC's tool stand ADS, for T210 and T245 Handles, comes with a quick cartridge exchanger.

Save time and change cartridges safely without switching the station off. ⚠ Be careful, the cartridges may be hot when placing them in the cartridge holder.

1. Removing

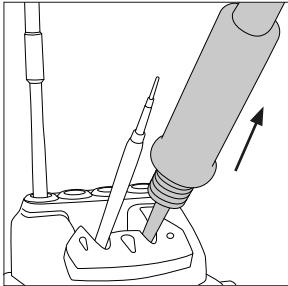

Place the cartridge in the extractor and pull the handle to remove it.

2. Inserting

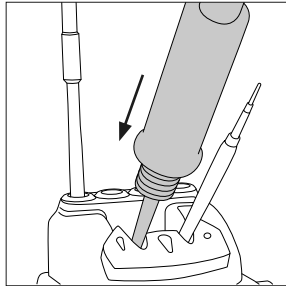

Place the handle on top of the new cartridge and press the handle down.

3. Fixing

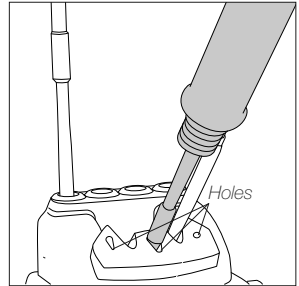

Depending on the shape of the tip, use one of the holes for fixing the cartridge.

Note: It is essential to insert the cartridge up to the mark for a proper connection.



Changing Cartridges - T470 Handles

1. Removing

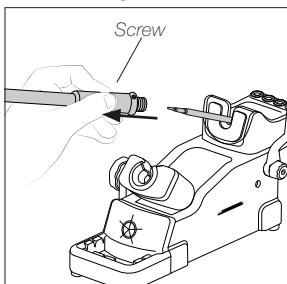

Loosen the handle screw. Place the soldering iron with the cartridge in the extractor and pull the handle to remove it.

2. Inserting

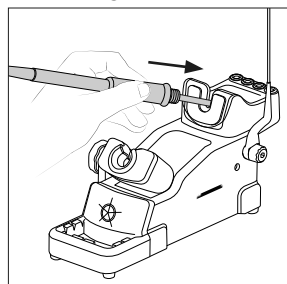

Place the handle on top of the new cartridge and press the handle down until the cartridge is fully seated.

3. Fixing

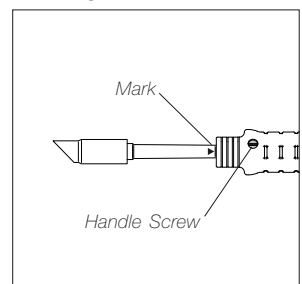

Make sure that the mark on the cartridge is aligned with the handle (see picture) to ensure a proper cartridge connection. Tighten the handle screw.

Changing Nitrogen Nozzles

If the outer cartridge diameter D_1 is smaller than the inner nozzle diameter D_2 , the nozzle can be removed without removing the cartridge.

⚠ When the nozzle is hot, use pliers to remove it.

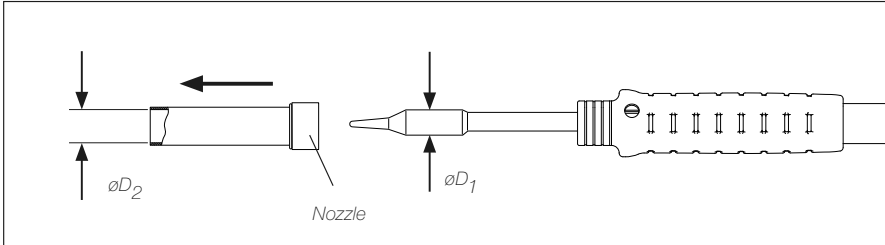

If the outer cartridge diameter D_1 is larger than the inner nozzle diameter D_2 . The cartridges must be removed first before the nozzle can be removed.

For T470 Handle loose the screw and remove the cartridge. Afterwards the nozzle can be removed.

⚠ When the nozzle is hot, use pliers to remove it.

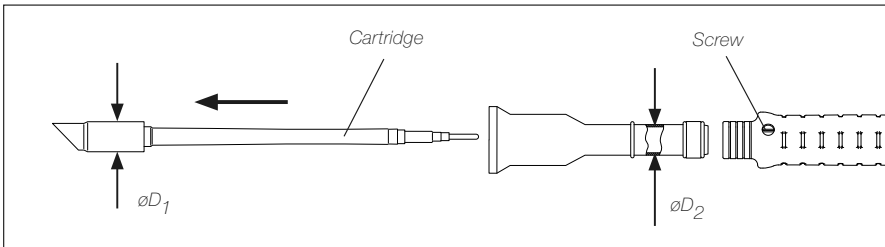

To insert a new cartridge proceed as described on page 7.

Cartridge Range

JBC offers for each handle different cartridge types. Find the model that best suits your soldering needs at www.jbctools.com.

T210 Handles work with C210 Cartridges, T245 Handles work C245 Cartridges and T470 Handles with C470 Cartridges.

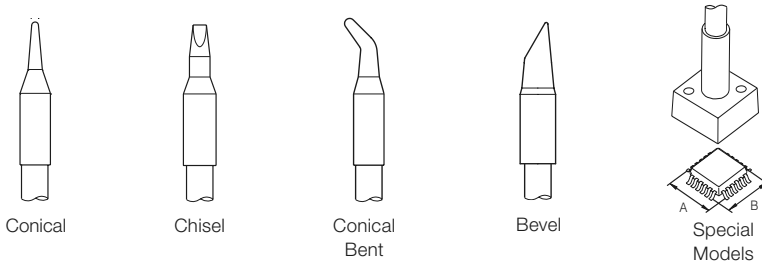

Changing Grips*

Replace the soft foam grips easily using slide-on tabs. **Note:** Choose the correct grip depending on your handle model.

Handle	Green grips	Blue grips	Black grips
T210, T210P, T210N	T8658	T3310	T3311
T245, T245G, T245P	T6057	T1528	T1530

1. Inserting Tabs

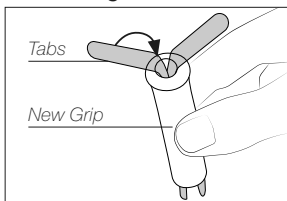

Put the slide-on tabs into the new grip.

2. Inserting Grip

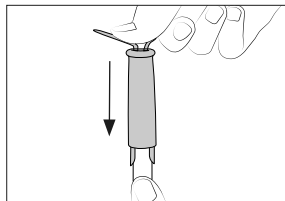

Push the grip with the tabs onto the handle.

3. Removing Tabs

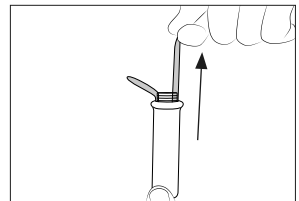

Hold the grip and pull the tab. Use pliers if necessary.

Replacing Sealing Plugs

The sealing plug prevents undesirable flux vapors or particles from entering the tool, and its usage is highly recommended. If the sealing plug is not used, particle inflow can lead to faulty performance due to poor cartridge contact or even to the tool being rendered unusable.

Note: Check the condition of the plug periodically and replace it as soon as wear or a crack appears in the sealing area of the cartridge.

 Before replacing the sealing plug, unplug the power supply and make sure the device is not hot.

Tool	Sealing Plug
T210	OB1000 **
T245, T470	OB2000 **

*** Each ref. contains 10 units.*

1. Removing Sealing Plug

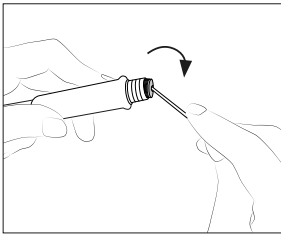

Introduce a small shaft or screwdriver, not deeper than 8 mm, and lift and pull out the sealing plug. Never use a cartridge to do this operation.

2. Mounting Position

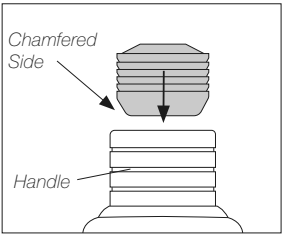

Note: The chamfered side has to be positioned towards the tool.

3. Inserting Sealing Plug

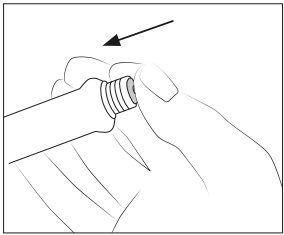

Push the sealing plug all the way into the tool.

Accessories

F3435

Fume extractor Ø6 for T245/T470 or

F3450

Fume Extractor Ø4 for T210

Clips can be easily removed for quick maintenance.

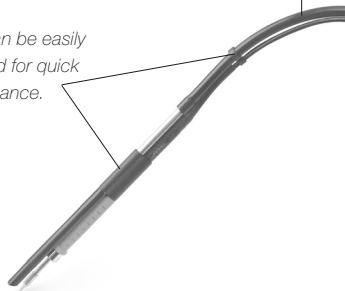

CC1001

Cable collector

Keeps the cable away from the soldering area.



Compatibility

Handle	Cartridge Range	Compact Stations	Modular System				
		CD	Stand	DI	DDE	DME	HDE
T210	C210	●	ADS	●	●	●	
T210P		●		●	●	●	
T245	C245	●		●	●	●	
T245G		●		●	●	●	
T245P		●		●	●	●	
T470	C245	●	ADS	●	●	●	
	C470		HDS				●
T470S	C245	●	ADS	●	●	●	
	C470		HDS				●
T470F	C245	●	ADS	●	●	●	
	C470		HDS				●
T470M	C245	●	ADS	●	●	●	
	C470		HDS				●
T470Z	C245	●	ADS	●	●	●	
	C470		HDS				●
T210N*	C210		DNS	●	●	●	
T245N*	C245			●	●	●	
T470N*	C245			●	●	●	
	C470						●

* The MNE Nitrogen Flow Regulator is required. Use the proper nozzle according to the cartridge.

Maintenance

- Before carrying out maintenance, always unplug the stand and the tool.
- Check periodically that the metal parts of the tool and the stand are clean to ensure detection of the tool when it is in the stand. Use a damp cloth or alcohol.
- Periodically check all cables and tubes connections.
- Replace any defective or damaged pieces. Use original JBC spare parts only.
- Repairs should only be performed by a JBC authorized technical service.

Safety



It is imperative to follow safety guidelines to prevent electric shock, injury, fire or explosion.

- Do not use the units for any purpose other than soldering or rework. Incorrect use may cause fire.
- Do not work on electrically live parts.
- The tool should be placed in the stand when not in use in order to activate the sleep mode. The soldering tip, the metal part of the tool and the stand may still be hot after the station is turned off. Handle with care, including when adjusting the stand position.
- Do not leave the appliance unattended when it is on.
- Avoid flux coming into contact with skin or eyes to prevent irritation
- Be careful with the fumes produced when soldering.
- Keep your workplace clean and tidy. Wear appropriate protection glasses and gloves when working to avoid personal harm.
- Utmost care must be taken with liquid tin waste which can cause burns.
- This appliance can be used by children over the age of eight as well as persons with reduced physical, sensory or mental capabilities or lacking experience provided that they have been given adequate supervision or instruction concerning use of the appliance and understand the hazards involved. Children must not play with the appliance.
- Maintenance must not be carried out by children unless supervised.

Notes

[illegible]

Notes

This image shows a single sheet of white paper with horizontal ruling lines. The lines are evenly spaced and run across the width of the page. There are no margins, text, or other markings on the paper.

Specifications

T210

Precision Handles

Net Weight:

Package Weight:

Ref. T210-A	56.8 g / 0.013 lb	106.5 g / 0.031 lb
Ref. T210-PA , Blue-Grip	56.8 g / 0.013 lb	106.5 g / 0.031 lb
Ref. T210-NA , Nitrogen	93 g / 0.013 lb	165 g / 0.031 lb

T245

General Purpose Handles

Ref. T245-A	66 g / 0.146 lb	115 g / 0.254 lb
Ref. T245-GA , Reinforced Cable	66 g / 0.146 lb	115 g / 0.254 lb
Ref. T245-PA , Blue-Grip	63.8 g / 0.141 lb	114.7 g / 0.253 lb
Ref. T245-NA , Nitrogen	93.2 g / 0.205 lb	165 g / 0.364 lb

T470

Heavy Duty Handles

Ref. T470-A	89.6 g / 0.198 lb	140.5 g / 0.310 lb
Ref. T470-SA , 3m / 9.84ft cable	140.3 g / 0.309 lb	190.9 g / 0.421 lb
Ref. T470-FA , Thermal Insulating Grip	90.7g / 0.200 lb	140.6 g / 0.310 lb
Ref. T470-MC , Thermal Insulating Grip and 3m / 9.84ft cable	137.8 g / 0.304 lb	188.6 g / 0.416 lb
Ref. T470-ZA , Tri-Lobed Grip	90 g / 0.198 lb	140 g / 0.309 lb
Ref. T470-NA , Nitrogen	93 g / 0.205 lb	165 g / 0.364 lb

For **T245-NA** and **T470-NA**:

- Package Dimensions: 277 x 73 x 50 mm
(L x W x H) 8.94 x 2.87 x 1.97 in

For **T470-MC**:

- Package Dimensions: 145 x 18 x 18mm
(L x W x H) 5.71 x 0.71 x 0.71 in

For **all other** handles:

- Package Dimensions: 235 x 40 x 40mm
(L x W x H) 9.25 x 1.57 x 1.57 in

Complies with CE standards
ESD safe

JBC

Warranty

JBC's 2 year warranty covers this equipment against all manufacturing defects, including the replacement of defective parts and labor.

Warranty does not cover product wear or misuse.

In order for the warranty to be valid, equipment must be returned, postage paid, to the dealer where it was purchased.



This product should not be thrown in the garbage.

In accordance with the European directive 2012/19/EU, electronic equipment at the end of its life must be collected and returned to an authorized recycling facility.



www.jbctools.com