



www.jbctools.com

INSTRUCTION MANUAL



FAE070

Flexible Arm with Clamp

This manual corresponds to the following reference:

FAE070

- Total length (tube compressed): 0.92 m / 36.22 in
- Max. operating distance: 0.70 m / 27.56 in (see page 4)

Packing List

The following items are included:



Round Metal Nozzle
for FAE



Flexible Arm 1 unit

already assembled:

Ref. **FAE083** Round Metal Nozzle for FAE

Clamp 2 units



Screws* 2 units
DIN-965 M4x20 - black

Washers* 2 units
DIN-9021 ø4.3 mm - black

Manual 1 unit
Ref. 0019184



* The supplied screws and washers can be used, as an alternative, to fix the arm to the workbench.

Assembly Example

FAE 070

Flexible Arm with
Clamp - \varnothing 50 mm
Take in mind the
installation dimensions
(see page 5 below)

Clamp for mounting the
flexible arm. The clamp
is suitable for a table
thickness of approx.
60 mm or less.

FAE010*

Flexible Hose \varnothing 50 mm
Total length: ~1.6 m / ~63 in

Connect the Flexible Hose to
Flexible Arm

* The flexible arm can also
be fixed on the workbench
with the supplied screws
and washers.

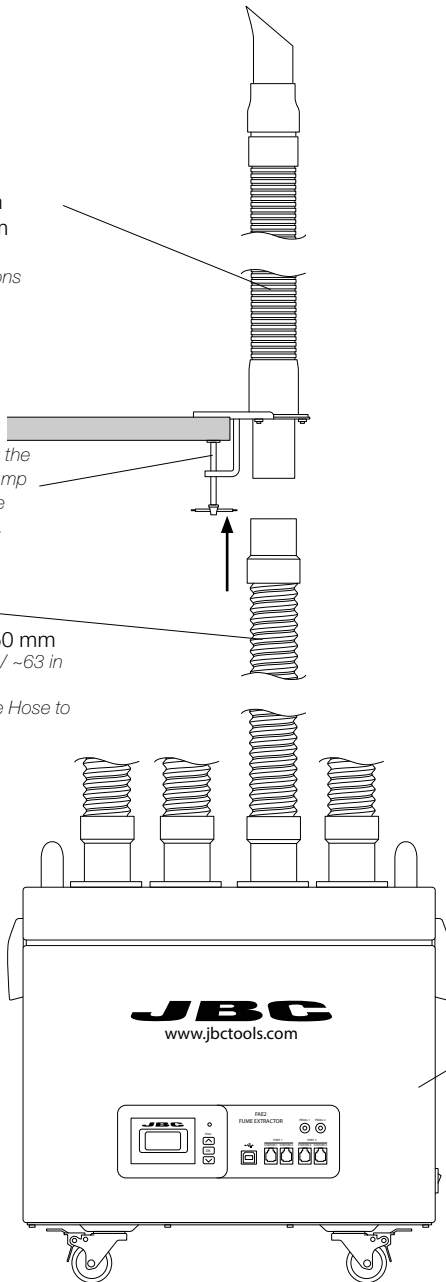
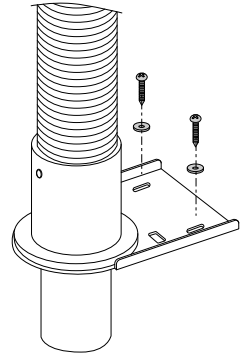

FAE2*
Fume Extractor

* Not included, sold separately.

How to use

Arm Installation

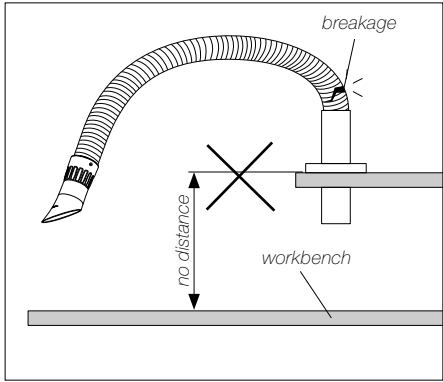

Do not install the flexible arm on shelves or higher levels than the work bench. Forced bending radii can cause the arm to break.

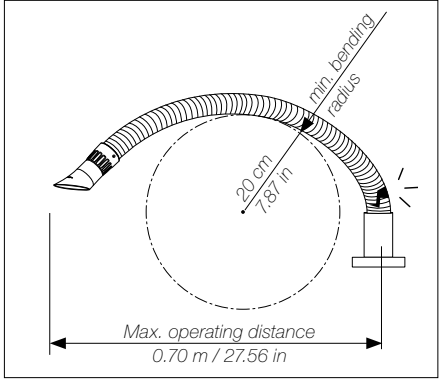

To avoid breaking the arm, do not extend the arm more than 100 cm / 39.37 in from the center of its base and do not go below the minimum bend radius of 20 cm / 7.87 in.

Arm Positioning

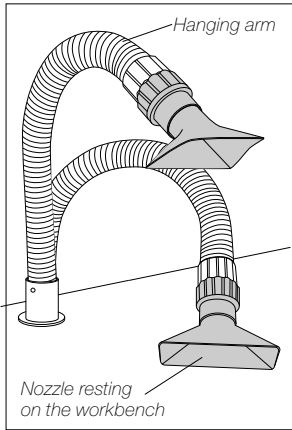

The arm can be used in an upright position with the nozzle hanging over the workplace or with the nozzle resting on the workbench.

Windings Compression

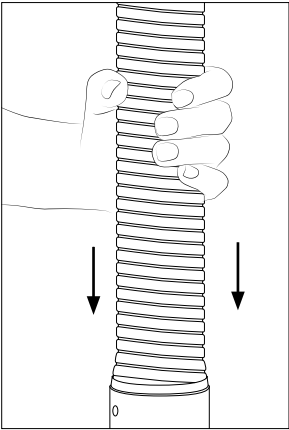

Note: In case of breakage, the windings can be plugged back into each other. To plug the windings back in, align them with each other and firmly push them together.

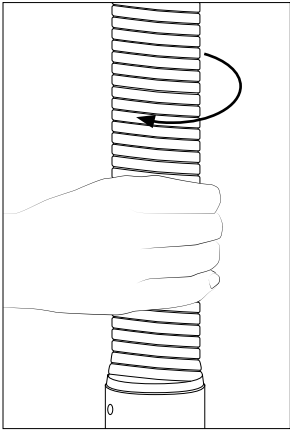

If the flexible arm loses firmness, it must be re-compressed. To increase compression, turn the arm slightly clockwise. Once the arm is compressed, readjust its position.

Nozzle Replacement

Nozzle and tube are connected to each other by means of a bayonet lock. This makes it easy to replace the nozzles.

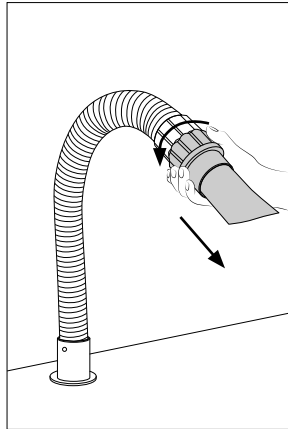

Disassemble the nozzle by holding the tube with one hand. With the other hand turn the nozzle counter-clockwise and pull it out.

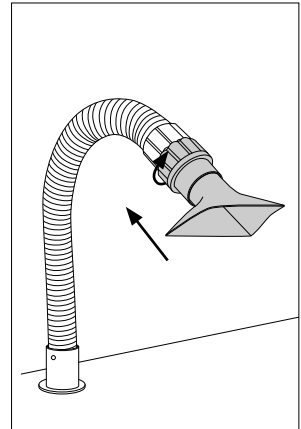

To install a new nozzle, turn the nozzle bayonet clockwise to lock it in place.

Accessories

The Supplied nozzle can be replaced by one of the following nozzles. Choose the one that best suits your needs.



FAE080

Rectangular Nozzle for FAE
aprox. 170 x 90 mm /
6.69 x 3.54 in

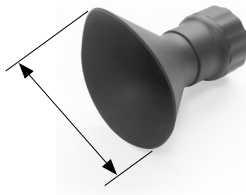

FAE081

Round Nozzle for FAE
aprox. \varnothing 120 mm /
 \varnothing 4.72 in

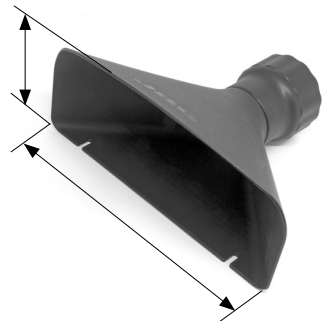

FAE082

Large Rectangular Nozzle for FAE
aprox. 227 x 107 mm /
8.94 x 4.21 in

Clamp Dimensions

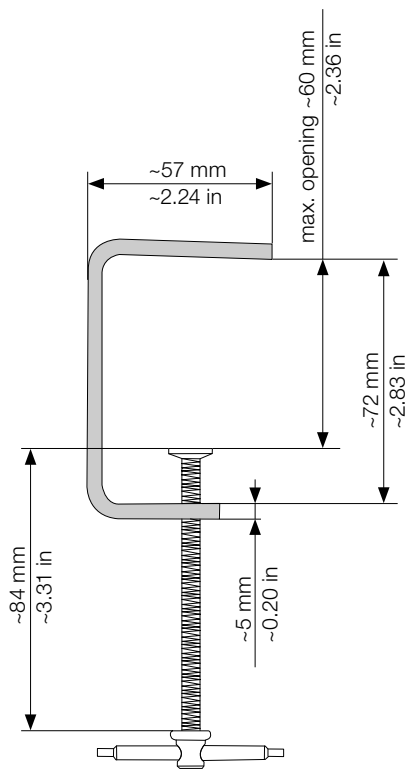

Notes

[illegible]

Specifications

FAE070

Flexible Arm with Clamp

Ref. **FAE070**

- | | |
|--------------------------------------|--|
| - Inner Tube Diameter: | ø50 mm / 1.97 in |
| - Total length (tube compressed): | 0.92 m / 36.22 in |
| - Max. operating distance: | 0.70 m / 27.56 in (see page 4) |
| - Fixing Clamp: | For a table thickness of approx. 60 mm or less |
| - Net Weight: | 2.2 kg / 4.89 lb |
| - Total Package Dimensions / Weight: | 1050 x 170 x 120 mm / 3.0 kg |
| (L x W x H) | 41.34 x 6.69 x 4.72 in / 6.61 lb |

Complies with CE standards.
ESD Safe.

JBC

Warranty

JBC's 2 year warranty covers this equipment against all manufacturing defects, including the replacement of defective parts and labor.

Warranty does not cover product wear or misuse.

In order for the warranty to be valid, equipment must be returned, postage paid, to the dealer where it was purchased.



This product should not be thrown in the garbage.

In accordance with the European directive 2012/19/EU, electronic equipment at the end of its life must be collected and returned to an authorized recycling facility.



www.jbctools.com