

# **JBC**

[www.jbctools.com](http://www.jbctools.com)

## **INSTRUCTION MANUAL**



### **FAE020**

Flexible Arm

This manual corresponds to the following reference:

**F AE020**

- Total length (tube compressed): 0.92m / 36.22 in
- Max. operating distance: 0.70 m / 27.56 in (see page 4)

**Packing List**

The following items are included:



**Flexible Arm** ..... 1 unit  
Ref. FAE020

**Screws** ..... 3 units  
DIN7982 - ø3.5x25 - black burnished  
Ref. 0019142



**Manual** ..... 1 unit  
Ref. 0019181

## Assembly Example

### FAE 020

Flexible Arm ø 50 mm

Take in mind the installation dimensions (see page 5 below)

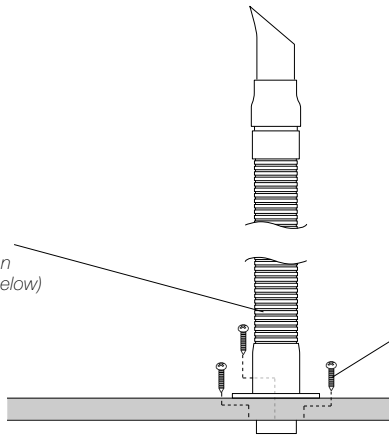

Fix the flange on your workbench with the supplied screws (more information at page 6)

### FAE010

Flexible Hose ø 50 mm

Total length: ~1.6 m / ~63 in

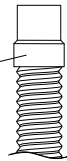

Connect the flexible Hose to the flexible Arm

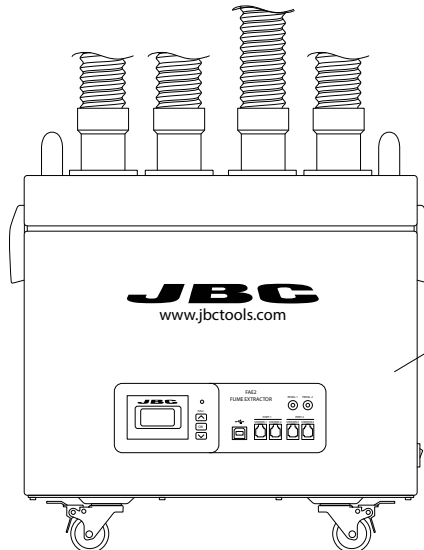

**FAE2**  
Fume Extractor

# How to use

## Arm Installation

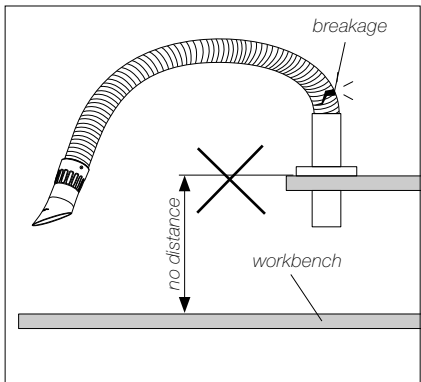

Do not install the flexible arm on shelves or higher levels than the work bench. Forced bending radii can cause the arm to break.

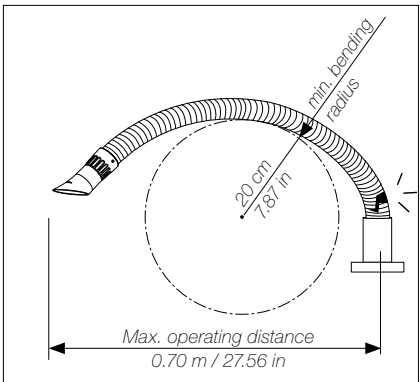

To avoid breaking the arm, do not extend the arm more than 100 cm / 39.37 in from the center of its base and do not go below the minimum bend radius of 20 cm / 7.87 in.

## Arm Positioning

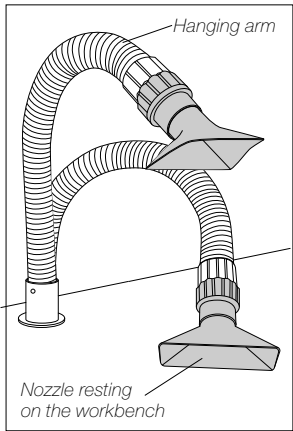

The arm can be used in an upright position with the nozzle hanging over the workplace or with the nozzle resting on the workbench.

## Windings Compression

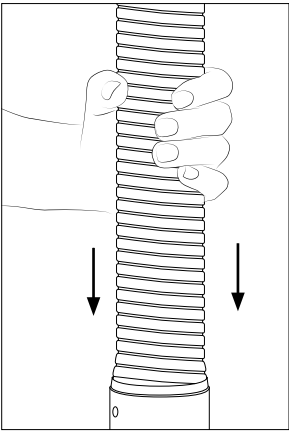

**Note:** In case of breakage, the windings can be plugged back into each other. To plug the windings back in, align them with each other and firmly push them together.

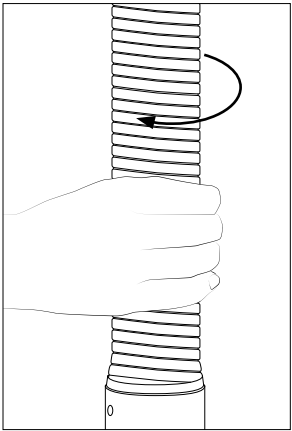

If the flexible arm loses firmness, it must be re-compressed. To increase compression, turn the arm slightly clockwise. Once the arm is compressed, readjust its position.

## Nozzle Replacement

Nozzle and tube are connected to each other by means of a bayonet lock. This makes it easy to replace the nozzles.

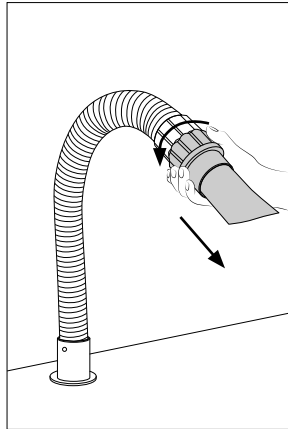

Disassemble the nozzle by holding the tube with one hand. With the other hand turn the nozzle counter-clockwise and pull it out.

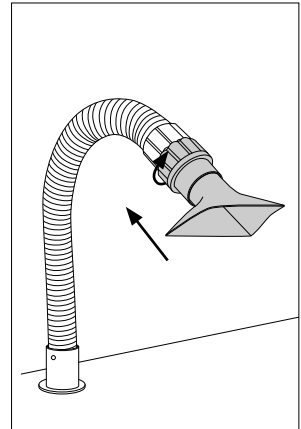

To install a new nozzle, turn the nozzle bayonet clockwise to lock it in place.

## Accessories

The Supplied nozzle can be replaced by one of the following nozzles. Choose the one that best suits your needs.



**FAE080**

Rectangular Nozzle for FAE  
aprox. 170 x 90 mm /  
6.69 x 3.54 in

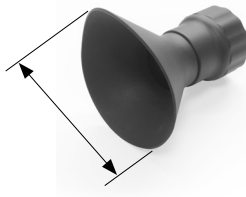

**FAE081**

Round Nozzle for FAE  
aprox.  $\varnothing$  120 mm /  
 $\varnothing$  4.72 in

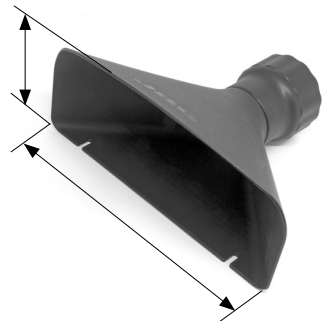

**FAE082**

Large Rectangular Nozzle for FAE  
aprox. 227 x 107 mm /  
8.94 x 4.21 in

# Dimensions Scheme for FAE020 Fixing

To assemble the flexible arm FAE020 (Ø50) for the first time follow these instructions:

- First make the large central hole in your workbench as shown in the drawing below.
- Place the FAE020 flange in the opening and mark the points for the three pilot holes.
- Take out the flange and drill the three holes at the marked spots. The hole diameter can be found in the dimension scheme:

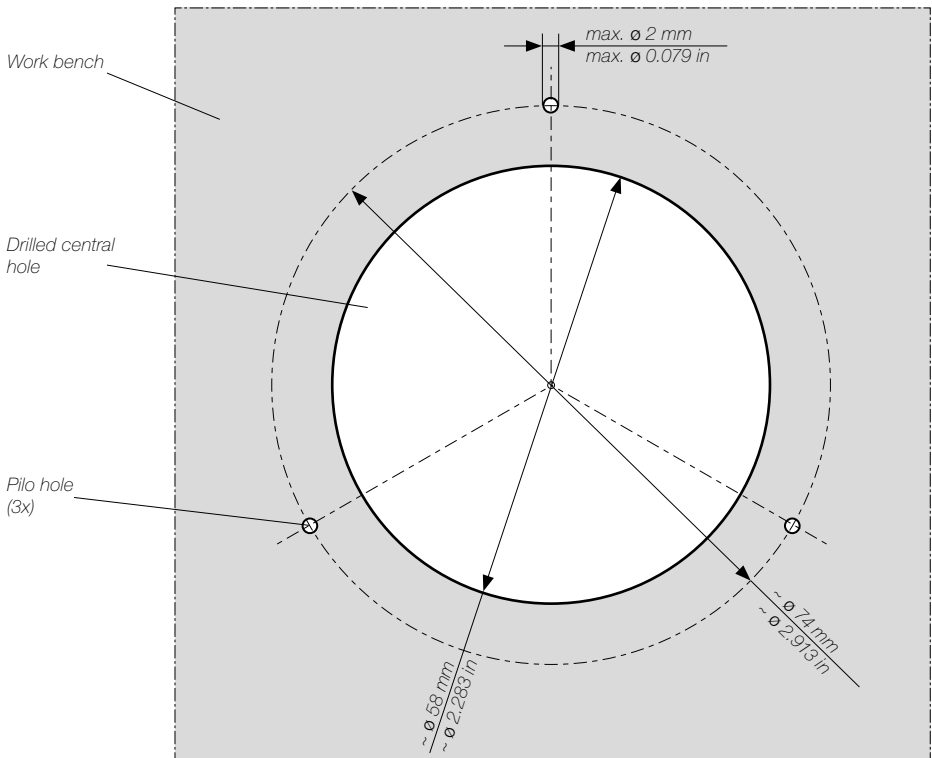

## Notes

[illegible]

## Specifications

### **FAE020**

#### **Flexible Arm**

Ref. **FAE020**

- |                                   |                                  |
|-----------------------------------|----------------------------------|
| - Inner Tube Diameter:            | ø50 mm / ø1.97 in                |
| - Total length (tube compressed): | 0.92 m / 36.22 in                |
| - Max. operating distance:        | 0.70 m / 27.56 in (see page 4)   |
| - Total Net Weight:               | 1,76 kg / 3.88 lb                |
| - Package Dimensions / Weight:    | 1050 x 170 x 120 mm / 2.5 kg     |
| (L x W x H)                       | 41.34 x 6.69 x 4.72 in / 5.51 lb |

Complies with CE standards.  
ESD safe.

# JBC

### **Warranty**

JBC's 2 year warranty covers this equipment against all manufacturing defects, including the replacement of defective parts and labor.

Warranty does not cover product wear or misuse.

In order for the warranty to be valid, equipment must be returned, postage paid, to the dealer where it was purchased.



This product should not be thrown in the garbage.

In accordance with the European directive 2012/19/EU, electronic equipment at the end of its life must be collected and returned to an authorized recycling facility.

