

**JBC**

**HD**

**HEAVY DUTY**

**JBC**

**ENGLISH / WARRANTY**

The JBC 2 years warranty, guarantees this equipment against all manufacturing defects, covering the replacement of defective parts and all necessary labour.

Warranty does not cover product wear due to use or mis-use.

In order for the warranty to be valid, equipment must be returned, postage paid, to the dealer where it was purchased enclosing this, fully filled in, sheet.

SERIAL N°

STAMP OF DEALER

DATE OF PURCHASE

**Reference Guide**

[www.jbctools.com](http://www.jbctools.com)

# HD / HEAVY DUTY

## CONTENTS

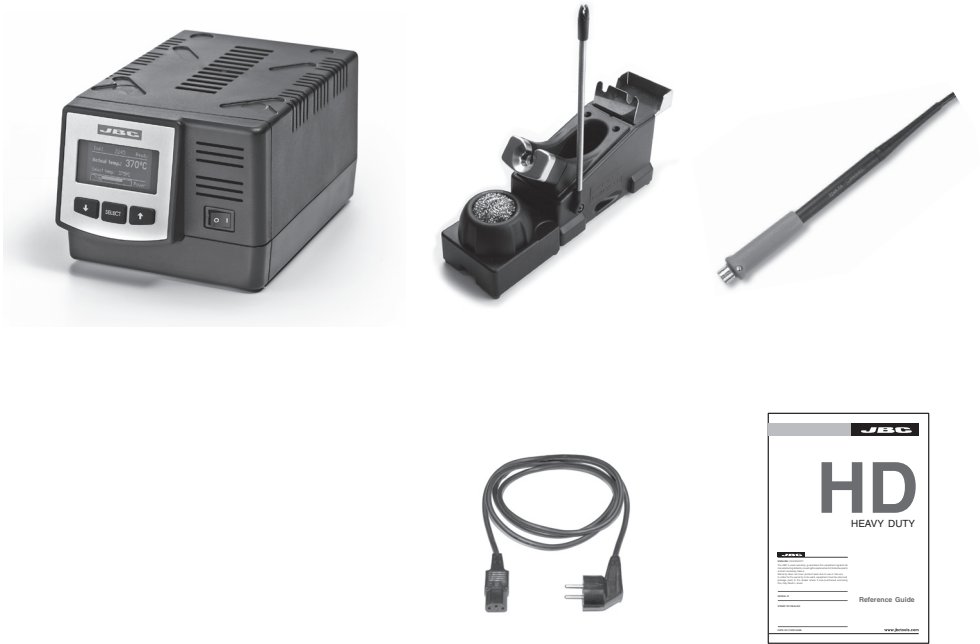

## HEAT MANAGEMENT

JBC stations intelligently manage the tool temperature:

**Work mode:** When the tool is used, pre-set work temperature is 350° C.

**Sleep mode:** When the tool is in the stand, the temperature goes down to 220° C.

**Hibernation mode:** After longer periods of inactivity (pre-set i.e 30 minutes), the power is cut off and the tool cools down to room temperature.

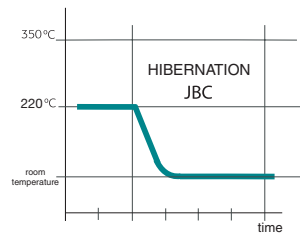
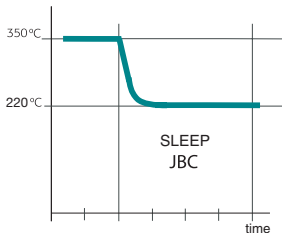
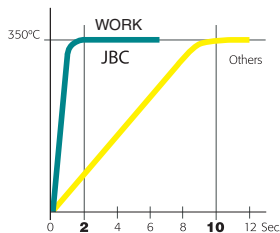

*The advantage of this heat management is lifespan increase which ensure low cost of ownership.*

**INSTALLATION****CONTROL UNIT**  
HD-2A

Power Cord  
Socket

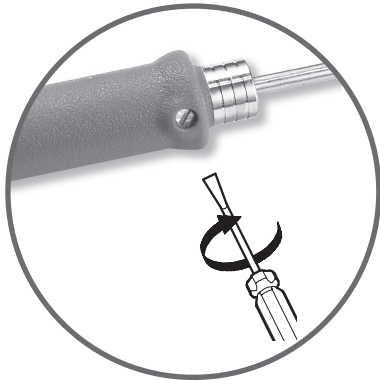
**SOLDERING STAND**  
HD-SA**TOOL**  
T245-TA**ATTENTION:**

We strongly recommend  
to tighten screw firmly  
to avoid cartridge from  
moving.

Connectable tools:

**T245-FA, T245-TA** and **T245-SA** with corresponding cartridge only version **C470**.

# HD / HEAVY DUTY

## WORKING

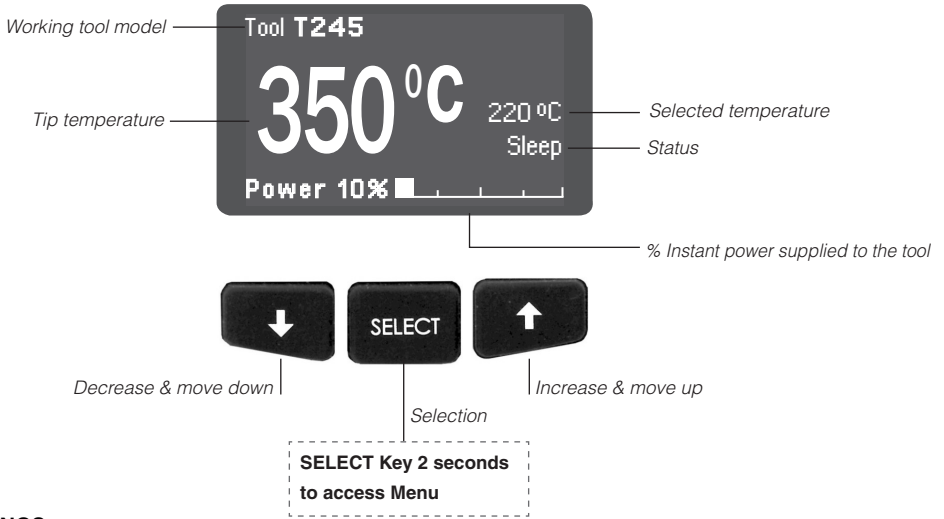

## SETTINGS

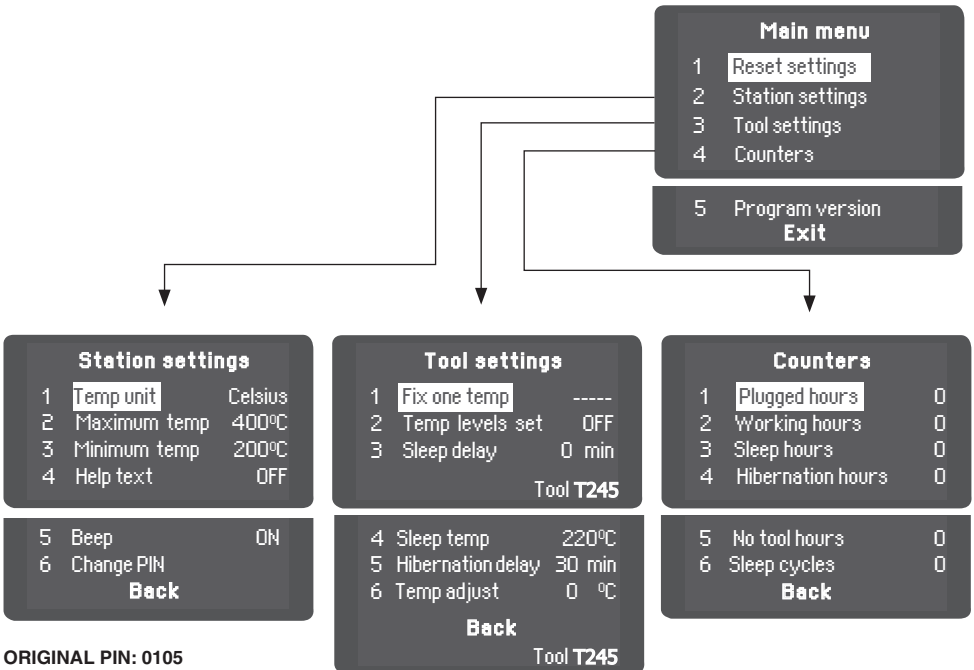

ORIGINAL PIN: 0105