

JBC

www.jbctools.com



ESD Tip Cleaner

Ref. CL6166

Packing list

The following items should be included:

ESD Tip Cleaner 1 unit
Ref. CL6166

Sponge1 unit
Ref. S0354

Manual 1 unit
Ref. 0018430



Features

Improve thermal transfer by cleaning the tip after each solder joint.

Brass wool
Ref. CL6210

Very effective cleaning method. It leaves a small layer of solder on the tip to prevent oxidation between cleaning and reflowing.

Sponge
Ref. S0354

The least harmful cleaning method. Keep the sponge damp with distilled water when working to avoid tip wear.

Splashguard

It prevents splashing of solder particles. Also used for sponge or brushes.

Non-slip base

No need to hold the base while cleaning tips.

ESD Tip Wiper
Ref. CL0240

A temperature resistant receptacle lets the operator remove excess solder by gentle tapping or wiping.



Tapping:



Tap to remove excess solder.

Wiping:



Use the slots to remove remaining particles.

Wool Replacement

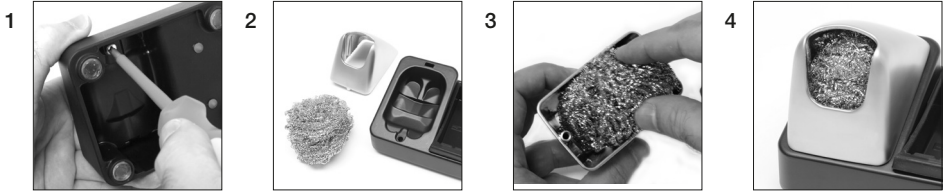

Metal Brush replacement

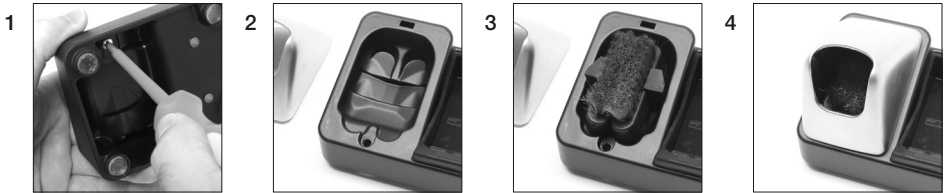

Tip Wiper replacement



Wiper can be easily removed for cleaning.

Optional

Inox wool
Ref. CL6205



Brushes
Ref. CL6220



Tip-tinner
Ref. TT-A



Sand
Ref. CL6211



Specifications

- Weight: 0.9 kg (1.9 lb)
- Dimensions: 110 x 90 x 90 mm (4.33 x 3.54 x 3.54 in)

ESD Safe
Complies with CE standards

JBC

Warranty

JBC's 2 year warranty covers this equipment against all manufacturing defects, including the replacement of defective parts and labour.

Warranty does not cover product wear or misuse.

In order for the warranty to be valid, equipment must be returned, postage paid, to the dealer where it was purchased.



This product should not be thrown in the garbage.

In accordance with the European directive 2002/96/EC, electronic equipment at the end of their life must be collected and returned to an authorized recycling facility.



Manual in other languages available on our website

www.jbctools.com