

# JBC

[www.jbctools.com](http://www.jbctools.com)

English



## Premium Complete Rework station with Pneumatic Pump

Ref. RMVE-A

## Index

Packing list.....3

### JT Hot Air station

Features..... 7  
 JT Changing nozzles.....8  
 JT-TA Changing the Heater Hose Set..... 9  
 JT-TA Replacing the Heating Element.....9  
 T260 Pick & Place.....9  
 Protectors & Extractors.....10  
 Operation & Process Control with JT.....11

### DDE Control Unit & MVE Module

Features.....14  
 Adjustable Stands.....16  
 Tip Cleaner.....17  
 T245 Compatible Handles.....18  
 T245 Changing Cartridges.....19  
 DR560 Changing Tips.....20  
 DR560 Changing the Heating Element.....21  
 DR560 Tin Deposit Cleaning.....22  
 DR560 Tip Care.....22  
 MVE Initial Setup.....23  
 MVE Changing the pump filters.....24  
 Desoldering Process DDE & MVE.....25  
 Operation with DDE.....26  
 Process Analysis.....28  
 Soldering Net.....29  
 Working with robots.....29  
 Station Software.....30

**Maintenance**.....31

**Safety**.....32

**Specifications**.....33

**Exploded View**.....34

## Packing List

The following items should be included:

**JT Control Unit** .....1 unit

Ref. JT-1B  
 JT-2B  
 JT-9B

**DDE Control Unit** .....1 unit

Ref. DDE-1A (120V)  
 DDE-2A (230V)  
 DDE-9A (100V)

**Pneumatic Desoldering Module**.....1 unit  
 Ref. MVE-A



**Stand** .....1 unit  
 Ref. JT-SB



**Stand** .....1 unit  
 Ref. AD-SD



**Stand** .....1 unit  
 Ref. DR-SD



**Heater hose set** .....1 unit  
 Ref. JT-T1A (100V / 120V)  
 JT-T2A (230V)



**General Purposes Handle** .....1 unit  
 Ref. T245-A



**Desoldering Iron**..... 1 unit  
 Ref. DR560-A



**JT Accessory set**  
Ref. 0012332

**Extractor stand\*** .....1 unit  
Ref. 0008752

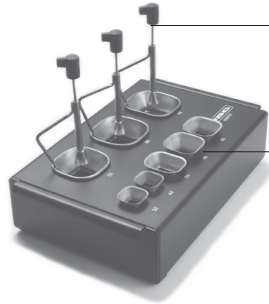

**Extractors\***  
Ref. E2184  
E2064  
E2052

**Tripod\***  
Ref. T2050 (Ø 39mm)  
T2250 (Ø 85mm)



**Protectors\***  
Ref. P2220  
P2230  
P2235  
P4000  
P4010

**Suction Tube\***  
Ref. 0932330



**Tip Cleaner**.....1 unit  
Ref. CL9885



**Suction Cups\***  
Ref. 0930110  
Ø 10 - 0934050 (x3)  
Ø 4.7 - 0934070 (x1)



**Nozzles**  
Ref. JN2015  
JN2012  
JN2020



**Cartridges**.....2 units  
Ref. C245903  
C245906



**Sponge** .....1 unit  
Ref. S0354



**Brush** .....1 unit  
Ref. CL6217



**DR560 Accessories**  
Ref. 0010211

**Tip cleaning set** .....1 unit  
Ref. 0965970



**Long Tip Cleaning set** .....1 unit  
Ref. 0965760

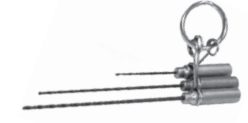

**Tips** .....3 units  
Ref. C560005  
C560013  
C560004



**Tin deposit** .....1 unit  
Ref. 0812620



**Spanner** .....1 unit  
Ref. 0780550



**Filter Box** .....1 unit  
Ref. 0780840  
*It contains 10 filters*



**Internal joint Case**.....2 units  
Ref. 0812360



**Metal tin deposit** .....1 unit  
Ref. 0812630



**Cotton Filter** .....1 unit  
Ref. 0781046  
*It contains 10 filters*



**Filter Box** .....1 unit  
Ref. 0005966  
*It contains 50 filters*



**Suction Filter** .....1 unit  
Ref. 0821830



\* These accessories are not supplied with JT-2QC / JT-1QC / JT-9QC stations.

**Pick & Place**.....1 unit  
Ref. T260-A



**Bent Needles Set**.....1 unit  
Ref. 0861660



**Straight Needles Set**.....1 unit  
Ref. 0901546



**Cups Set**.....1 unit  
Ref. 0940163



**Union Flanges** .....1 unit  
Ref. 0011356



**Stand Cable**.....2 units  
Ref. 0011283



**Module Cable** .....1 unit  
Ref. 0014874



**Cleaning stick** .....1 unit  
Ref. 0786640



**Escape Filter** .....1 unit  
Ref. 0008446



**Power cords**

For DDE ..... 1 unit  
Ref. 0013671 (100/120V)  
0010569 (230V)



For JT.....1unit  
Ref. 0009417 (100V/120V)  
0009401 (230V)



**Manual** .....1 unit  
Ref. 0014689



**JT Features**

**USB-B connector**  
Update the station software from the JBC website

Activation of suction pump



**Suction Tube**  
Ref. 0932330  
For tripods and extractors



**Heater Hose set**  
Ref. JT-T1A (100V - 120V)  
JT-T2A (230V)



Other connectable tools:  
**Precision Heater hose set**  
Ref: TE-TB

To Pedal  
Ref. P-005



Equipotential connection  
Power Socket  
Fuse

## JT-TA Changing nozzles

### 1. Placing

Place the heating element so that the bottom of the nozzle fits into the changer.

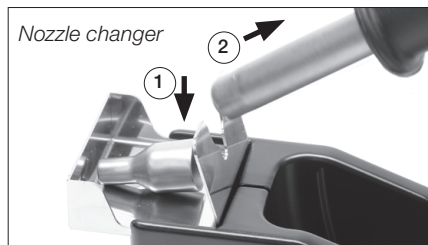

### 2. Pulling

Pull gently to release the nozzle.

In case of misalignment of the nozzle with the JT-TA heater:

1. Bend down the nozzle tab with a screwdriver or flat nosed pliers.

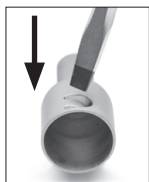

2. Insert the nozzle into the JT-TA Heater again.

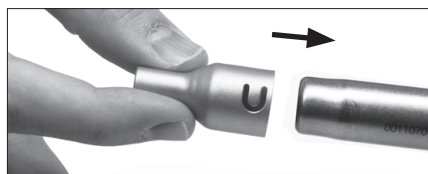

## Compatible Nozzles

The JT-TA works with JT nozzles. Find the model that best suits your soldering needs in [www.jbctools.com](http://www.jbctools.com)

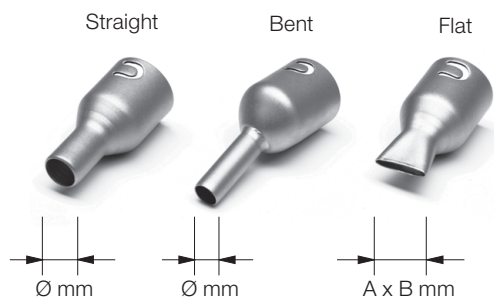

Ref.	Shape	Size
JN2020	Straight	Ø 8mm
JN8417	Straight	Ø 10mm
JN2015	Bent	Ø 4mm
JN2012	Bent	Ø 6mm
JN6633	Bent	Ø 8mm
JN7637	Flat	10 x 2mm
JN7638	Flat	20 x 2mm
JN7639	Flat	30 x 2mm

## JT-TA Changing the Heater Hose Set

1. Ensure that the tool is turned off.
2. Use a wrench to unscrew the connecting nut.
3. Pull back the connecting nut.
4. Tube end must be inserted so that the longitudinal rib fits into the groove.
5. Follow the same steps conversely.



## JT-TA Replacing the Heating Element

Only perform this operation when the element is cold and the unit is disconnected from the mains.

1. Loosen the screw.
2. Pull element away from the handle.
3. Connect new heating element, ensuring its seated all the way in.
4. Replace the screw.

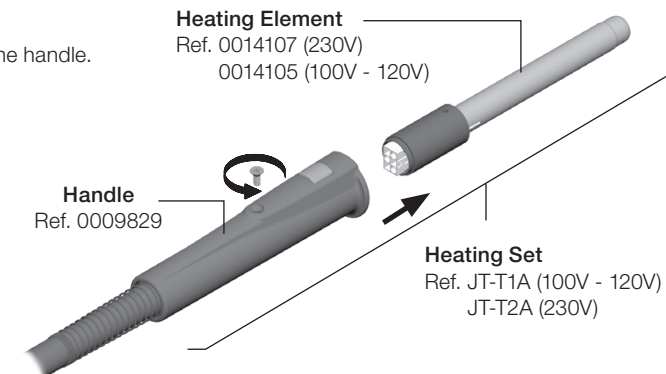

## T260 Pick & Place

This tool helps you easily place and remove SMDs of any size thanks to the suction provided by the station.

Press the button to start/stop the suction

Choose the suction cup that best fits the component.

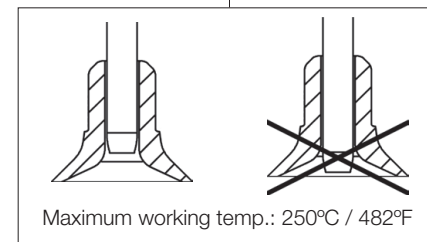
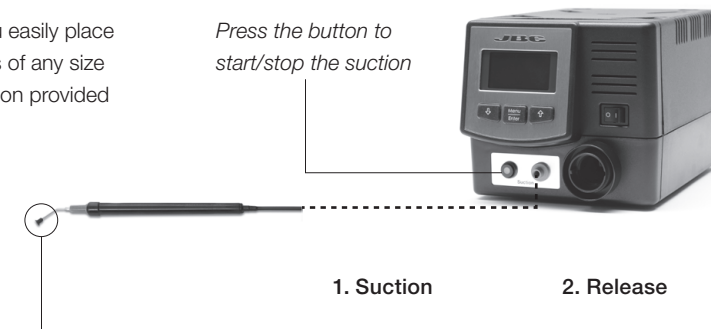

Insert the needle with the appropriate suction cup for a correct suction process.

You should avoid the needle to stick out of the lower part.

### 1. Suction

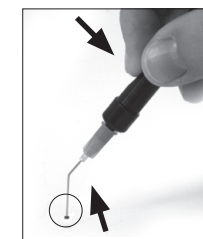

Once activated the suction button, cover the pen hole with your finger and pick the component.

### 2. Release

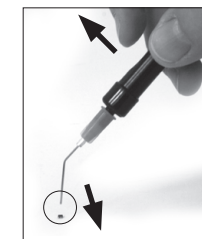

Lift your finger to release the component on the appropriate place.

## Protectors & Extractors

**For small components** (fig. 1 and 2).  
We recommend using the protector + tripod

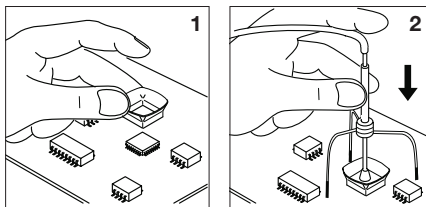

### Protectors

	* Ref.	AxB (mm)	* Ref.	AxB (mm)
	P3353	4,3 x 3	48	P2230 15 x 15
	P3786	5,2 x 5,2	60	P4010 17 x 17
	P3352	5,2 x 7,5		P4005 18 x 29
	P3355	5,2 x 9,5		P4030 18,5 x 18,5
	P3356	6,2 x 4,2		P1068 18,5 x 24
	P3785	7,2 x 7,2		P2685 28,5 x 28,5
	P3784	8,2 x 8,2		P4085 31,5 x 31,5
	P4035	9 x 13		P2672 33 x 46
	P4040	9,5 x 19		P4002 50 x 50
	P4080	9,5 x 21		P3357 52,5 x 14
32	P2220	10 x 10		
	P4045	10,5 x 21		
	P4090	11 x 16		
24	P2235	12 x 17		
	P1249	12 x 23		
44	P4000	12,5 x 12,5		
	P3354	13,2 x 13,2		
	P4025	13,5 x 21,5		

\* Reference Desk

**For big components** (fig. 3 and 4).  
We recommend using the extractors

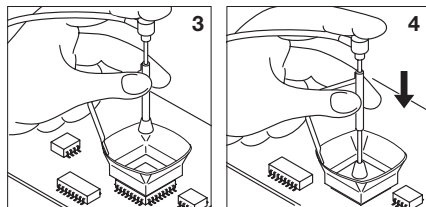

### Extractors

	* Ref.	AxB (mm)	* Ref.	AxB (mm)
52	E2052	20 X 20	E2124	45 X 45
64	E2064	20 X 26		
80	E2184	24 X 24		
	E2068	27 X 27		
	E4020	28,5 X 28,5		
	E4015	31,5 X 31,5		
	E2084	33 X 33		
	E2100	38 X 38		

### Tripods

* Ref.	øC (mm)
T2050	39
T2250	85

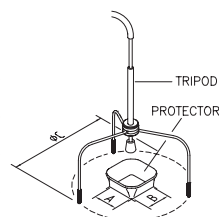

### Manual extractor

* Ref.	øD (mm)
E2190	7



## Operation with JT station

### 1. Placing



Position the suction cup.

### 2. Heating



Push the button for hot air heating. The solder melts.

### 3. Releasing

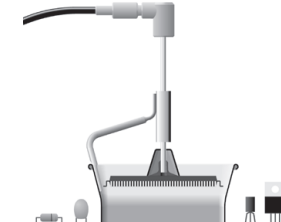

The component lifts off automatically.

## Process Control

### Manual Mode

Time to stop 45 seconds  
Temp °C 400 | Air % 85  
Current temperature 400°C Select  
Selected temperature 400°C Select  
Power 70%  
% Instant power supplied to heater

↓ Menu/Enter ↑  
Access Menu (press key 2 seconds) & Confirm Selection

You can switch between operating modes (Manual Mode / Profile Mode) by pressing the "increase" and "decrease" keys simultaneously for 2 seconds. (Only when mode profiles is ON)

## Program Mode

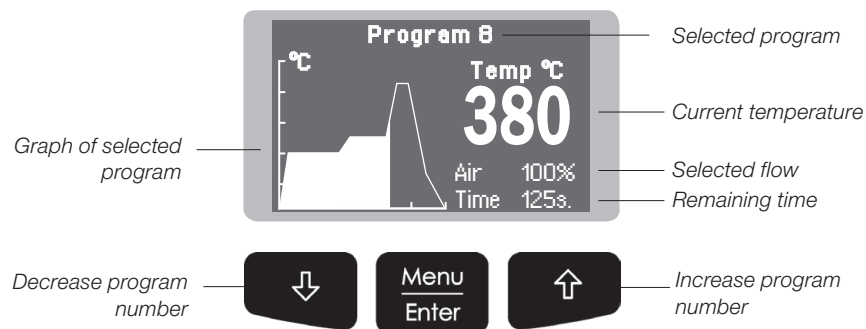

## Edit Program

This option allows you to edit or create a program.

First, you must select the program to edit and then modify the points that make up the program.

Each program is composed of 9 points, each point consisting of 3 parameters:

1. Time (seconds)
2. Temperature (°C / °F)
3. Flow rate (%)

You can delete the last point of the program by selecting "-----" in the time parameter.

It should be taken into account that the regulation range permitted by the station is between 150°C and 450°C, whereby it is not possible to create temperature ramps between room temperature (Toff) and 150°C.

The station can store up to 25 temperature programs.

The first three programs are edited as an example.

## Copy Program

This option allows you to copy a program.

You must select the program source and the program destination (where it will be copied).

## Delete Program

This option will allow you to delete a previously selected program.

## Menu Screen

Original PIN: 0105

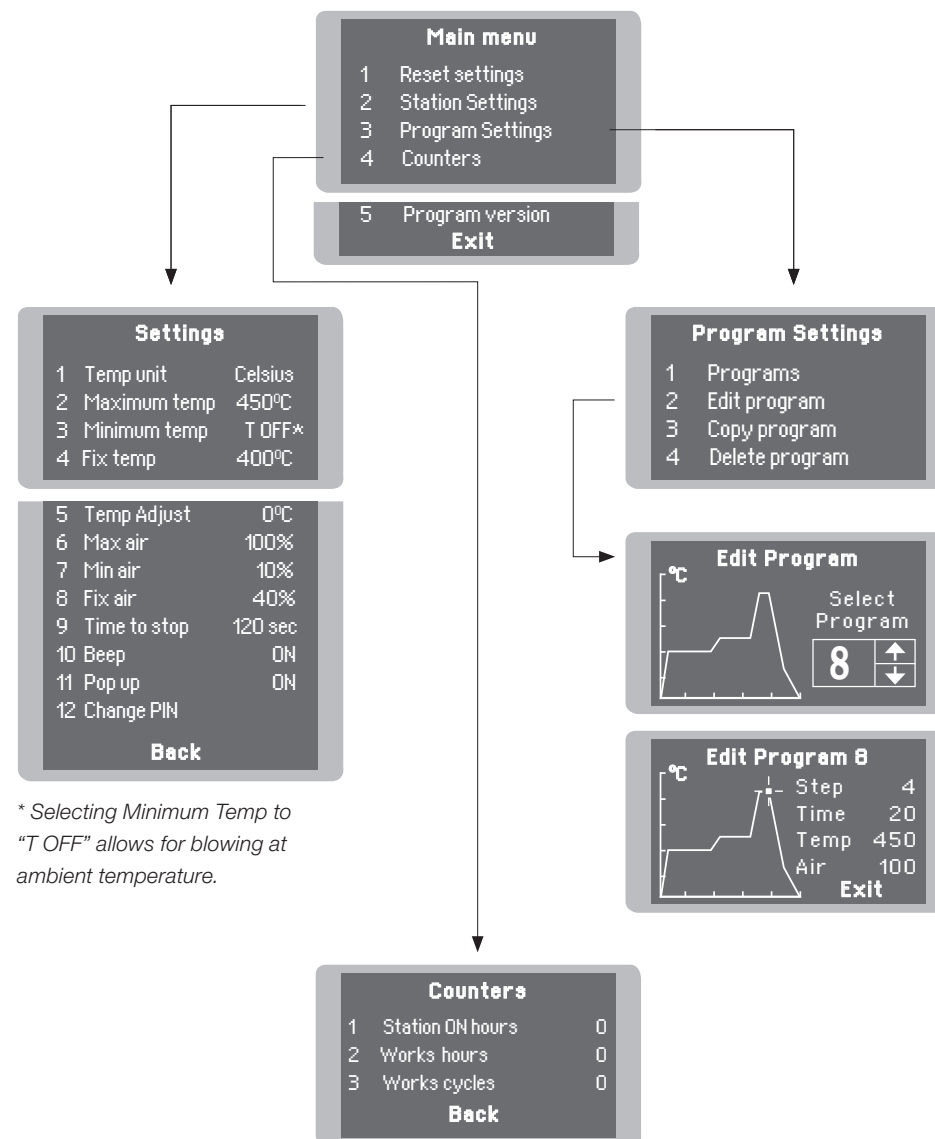

## DDE & MVE Features

Work simultaneously with **up to 2 tools** and join each station port with **1 module + 1 pedal** (Peripherals).

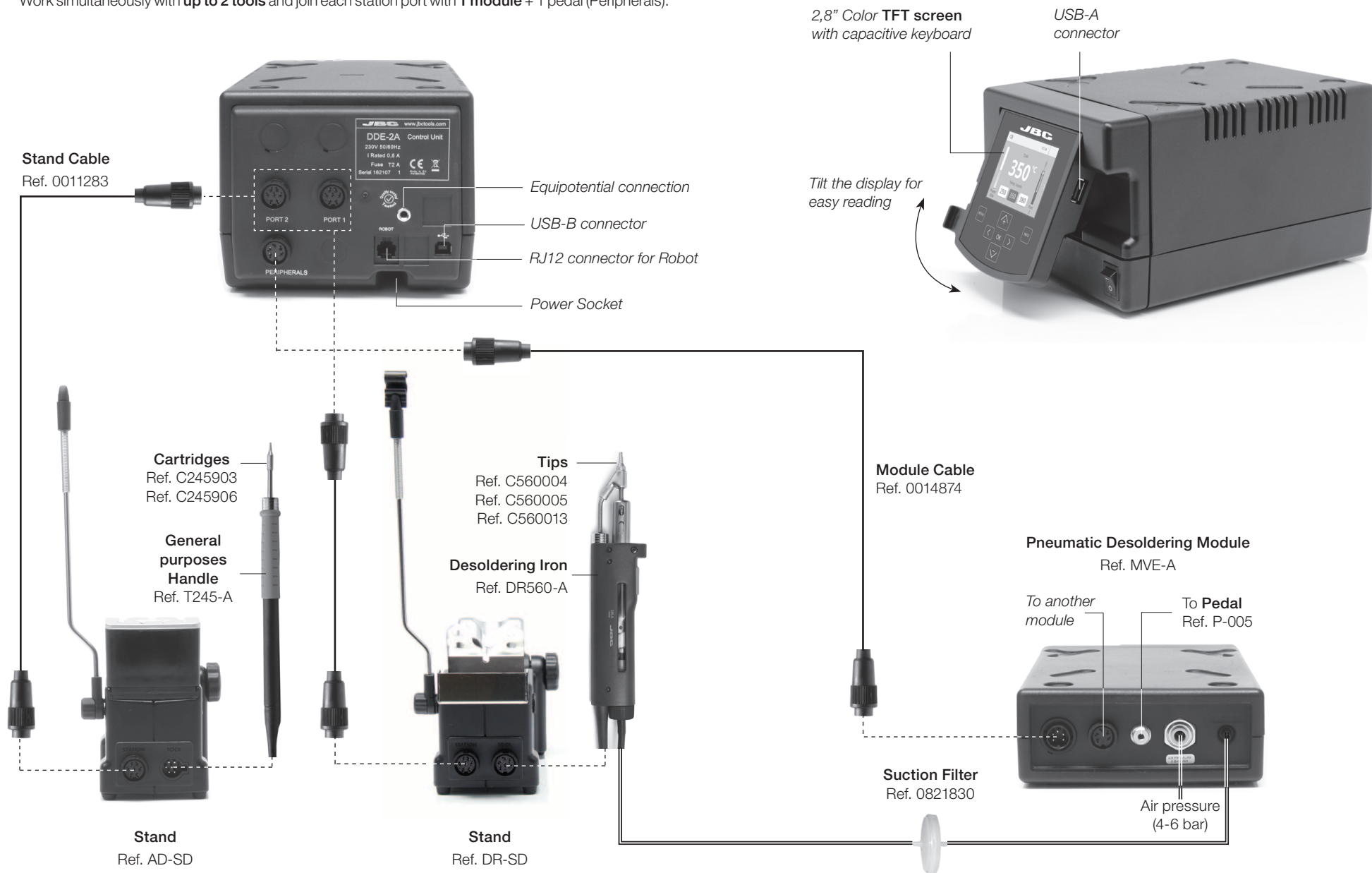



## Adjustable Stands

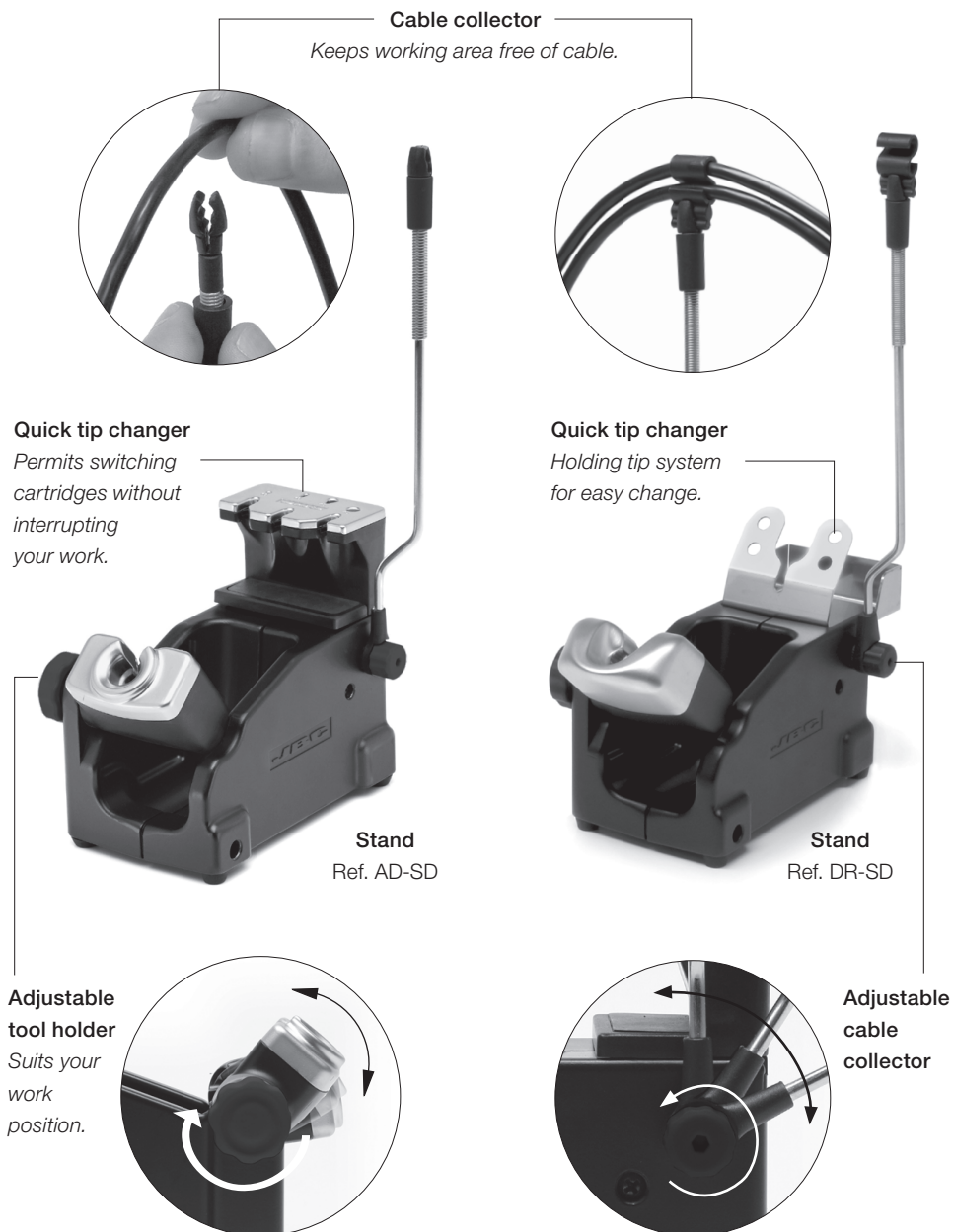

## Tip Cleaner

Improve thermal transfer by cleaning the tip after each solder joint.

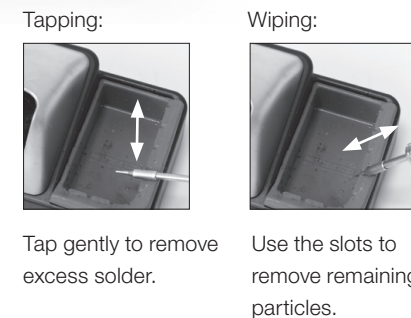
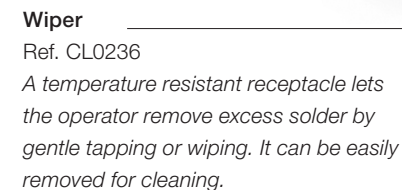
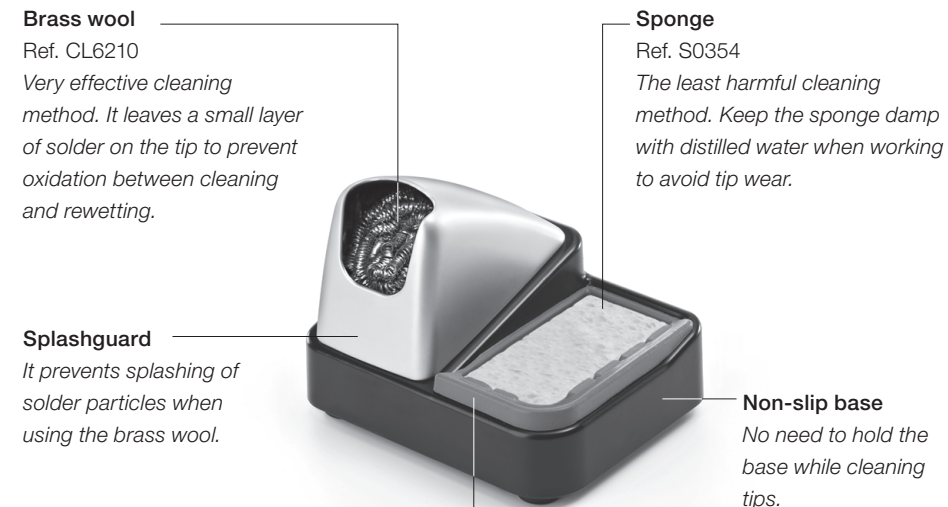

### Optional



## T245 Compatible Handles

For C245 Cartridge range

### General Purposes

Ref. T245-A



### Blue Grip

Ref. T245-PA

It has a blue grip to quickly distinguish it from other handles.



### Non-slip Grip

Ref. T245-B



### Soft Grip and Thermal Insulation

Ref. T245-C

For intensive jobs requiring high thermal power.



## T245 Changing Cartridges

Save time and change cartridges safely without switching the station off.

### 1. Removing

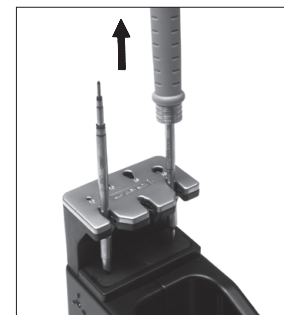

Place the handle in the extractor and pull to remove the cartridge.

### 2. Inserting

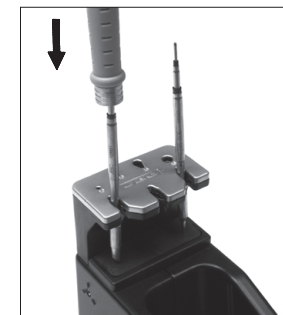

Place the handle on top of the new cartridge and press down slightly.

### 3. Fixing

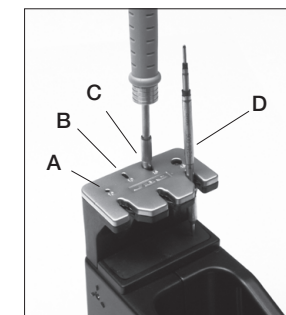

Use the holes for fixing the cartridge\* as follows:  
**A.** For straight C210.  
**B.** For curved C210.  
**C.** For curved C245.  
**D.** For straight C245.

### \*Important

It is essential to insert the cartridges as far as the mark for a proper connection.

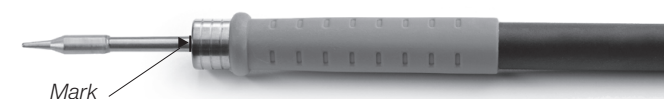

### Compatible cartridges

The T245 handle works with C245 cartridges. Find the model that best suits your soldering needs in [www.jbctools.com](http://www.jbctools.com)



Round



Chisel



Round bent



Bevel

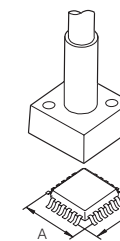

Special models

## DR560 Changing Tips

This operation should be done while the tip is hot, not below 250°C, so that any tin left inside is in molten state.

### 1. Removing

Unscrew the tip using the spanner supplied.



### 2. Inserting

Fit the new tip and tighten with the spanner to make sure it is air tight.

### Compatible Tips

The DR560 works with C560 tips.

Find the model that best suits your soldering needs in [www.jbctools.com](http://www.jbctools.com)

Here are some C560 tips in real size (in mm):

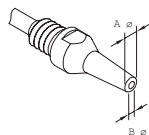

**C560-001** ØA=1,4 ØB=0,6 Ømax. pin=0,4

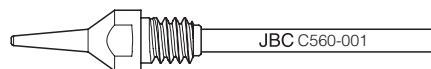

**C560-002** ØA=1,8 ØB=0,8 Ømax. pin=0,6

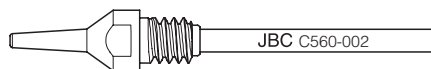

**C560-014** ØA=2,5 ØB=0,8 Ømax. pin=0,6

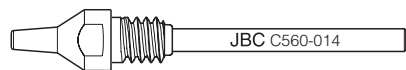

**C560-003** ØA=2,7 ØB=1 Ømax. pin=0,8

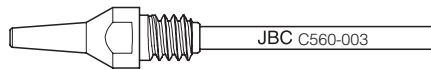

**C560-004** ØA=3,2 ØB=1,3 Ømax. pin=1,1

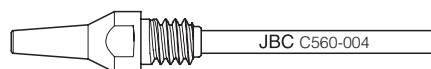

**C560-009** ØA=5 ØB=1,3 Ømax. pin=1,1

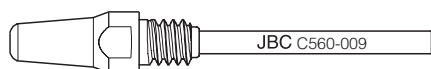

## DR560 Changing the Heating Element

To perform this operation, turn off the station or disconnect the tool.

### 1. Loosening

The deposit lid needs to be loosened.



### 2. Removing

Loosen the screw as shown and remove the Heating Element.

### 3. Placing

Place the new Heating Element and follow the steps conversely.



### Important

For a proper connection it is essential to insert the cartridge by lining it up to the mark ►.

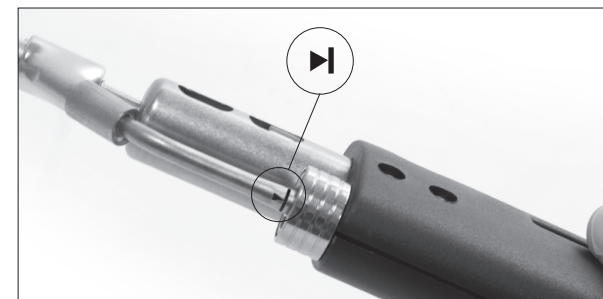

## DR560 Tin Deposit Cleaning

### 1. Removing the lid

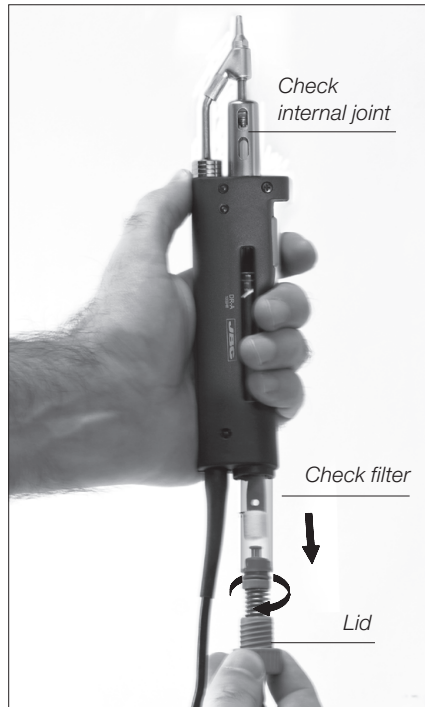

The lid must be removed with the DR560 in vertical position.

### 3. Inserting the deposit

The deposit must be inserted with coil filter in place, positioned between the 2 lines marked on the tin deposit. Then the whole unit must be closed by screwing the lid.



### 2. Cleaning



Remove the coil to clean the inside of the deposit with the stick supplied.



The filter and internal joint must be checked and replaced if dirty or damaged.

## DR560 Tip Care

The intake tube should be periodically cleaned by the largest rod.

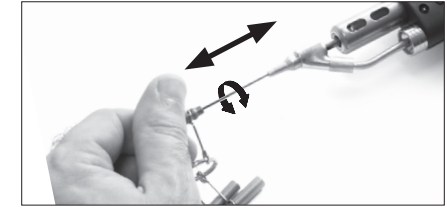
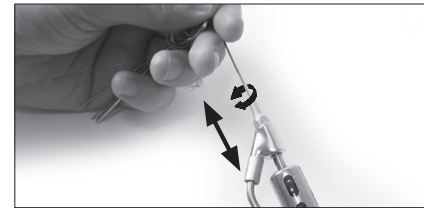

### Important

DO NOT press the vacuum pump button while tinning the desoldering tip, as the fumes given off by the flux would quickly block the ducts and the air filter.

## MVE Initial Setup



### Peripherals

After connecting the module, enter the **Peripherals** Menu and select the station port which you want to join with it.

1. Select the module from the list of peripheral connections. Remember your first connection is denoted as "a", the second being "b", etc. (e.g. MV\_a, MV\_b,...)

2. Press Menu or Back to save changes. Once set up, you can change the module settings by entering the **Peripherals** Menu.

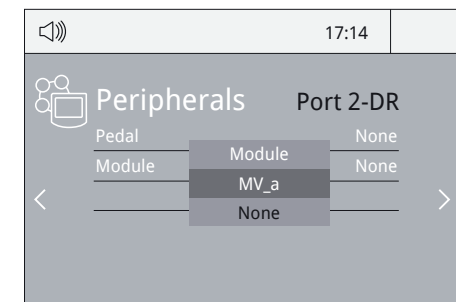

## MVE Changing the pump filters

- Keep the casing clean by using a damp cloth. Periodically check all cable and tube connections.
- Keep filters clean to ensure proper solder suction and replace them when necessary.

### Important

Do not use sharp pointed objects to open the suction filter.

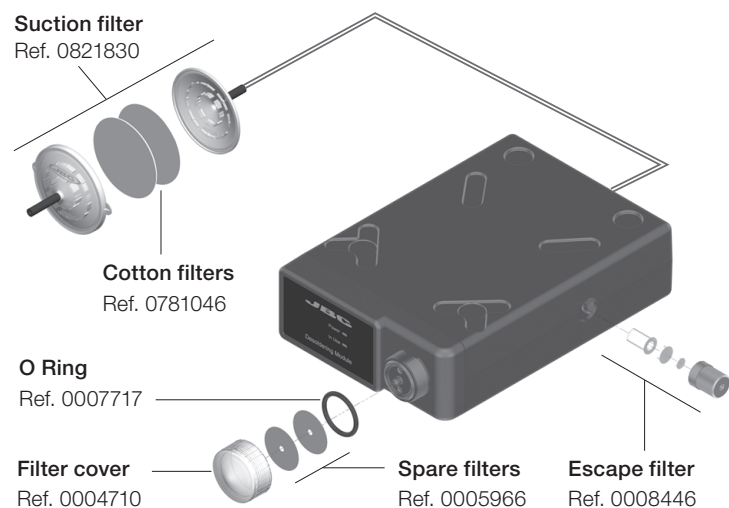

## Desoldering process with DR560 & MVE

Use a tip with a larger diameter than the pad to achieve maximum aspiration and thermal efficiency.

### 1. Placing

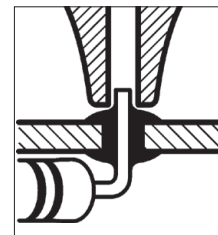

Place the tip on the component terminal.

### 2. Rotating

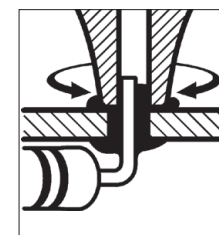

When the solder liquefies, gently rotate the tip so that the component can be lifted off.

### 3. Aspirating

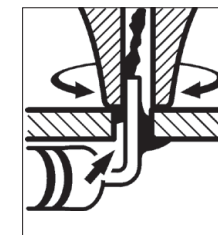

Press the vacuum pump button long enough to remove the solder.

After pressing the desoldering key there is a slight delay until the self-contained vacuum pump stops. This makes sure that the vacuum circuit is completely empty.

If any solder remains are left on a terminal after desoldering it, resolder it with fresh solder and repeat the desoldering operation.

## Operation with DDE Control Unit

### The JBC Exclusive Heating System

Our revolutionary technology is able to recover tip temperature extremely quickly. It means the user can work at a lower temperature and improve the quality of soldering. The tip temperature is further reduced thanks to the Sleep and Hibernation modes which increase the tip life by 5.

#### 1. Work



When the tool is lifted from the stand the tip will heat up to the selected temperature.

#### 2. Sleep



When the tool is in the stand, the temperature falls to 180°C / 360°F (preset sleep temperature).

#### 3. Hibernation



After longer periods of inactivity (pre-set to 30 min.), the power is cut off and the tool cools down to room temperature.

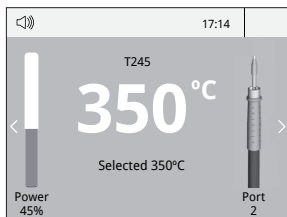

Tools Menu:

- Set temperature limits
- Select temperature levels



Tools Menu:

- Set Sleep temperature
- Set Sleep delay (from 0 to 9 min or no Sleep)

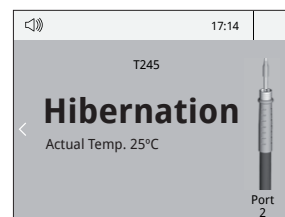

Tools Menu:

- Set Hibernation delay (from 0 to 60 min or no hibernation)

## Work Screen

The DDE-A offers an **intuitive user interface** which provides **quick access** to station parameters.



### Menu Options

Press INFO for each parameter description.

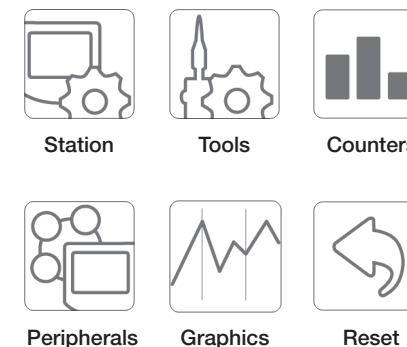

### System notifications (Status Bar)

- USB flash drive is connected.
- Station is controlled by a PC.
- Station is controlled by a robot.
- Station software update. Press INFO to start the process.
- Warning. Press INFO for failure description.
- Error. Press INFO for failure description, the type of error and how to proceed.

## Process analysis



Graphics

By pressing **Graphics** in the main MENU, temperature and power figures in real time are displayed for each port. This helps you decide which tip to use to obtain the best quality solder joints.

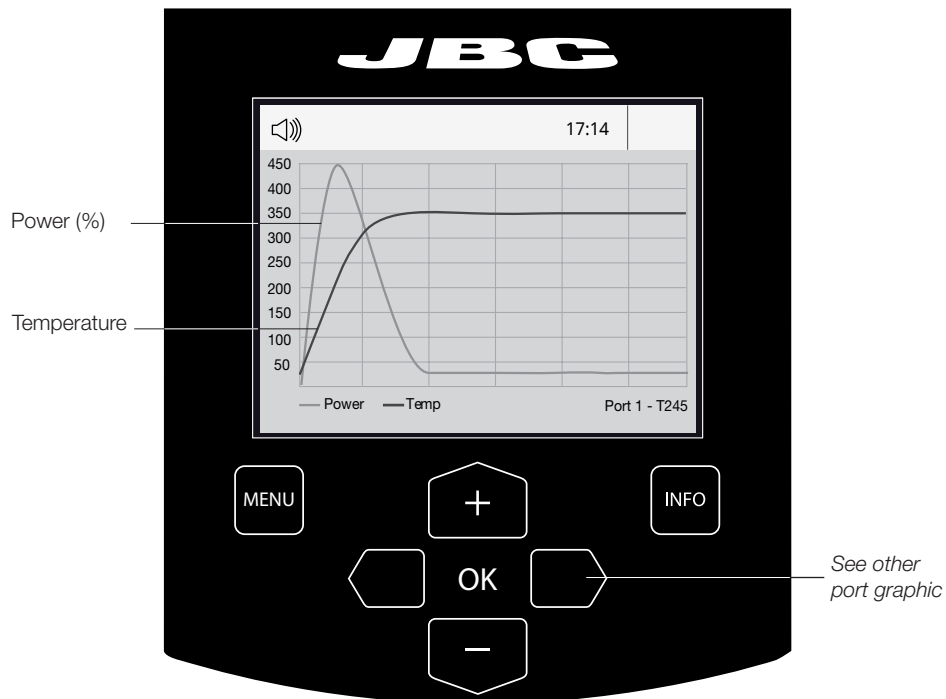

## Export graphics

Insert a USB flash drive into the USB-A connector to start saving your soldering process in csv format.



## Soldering Net

Remotely manage and monitor as many stations as your Windows PC can handle.

1. Download the **JBC Manager software** and the user manual from [www.jbctools.com/manager.html](http://www.jbctools.com/manager.html)
2. Connect the stations via USB-B connector and the PC will automatically detect them.
3. The notification  will be displayed on the station.

### Functions:

- Set all the station parameters from your PC.
- Organize groups of stations and set all their parameters at the same time.
- Store specific configurations for later uses.
- Analyze the soldering graphics of the stations on your PC and export them.

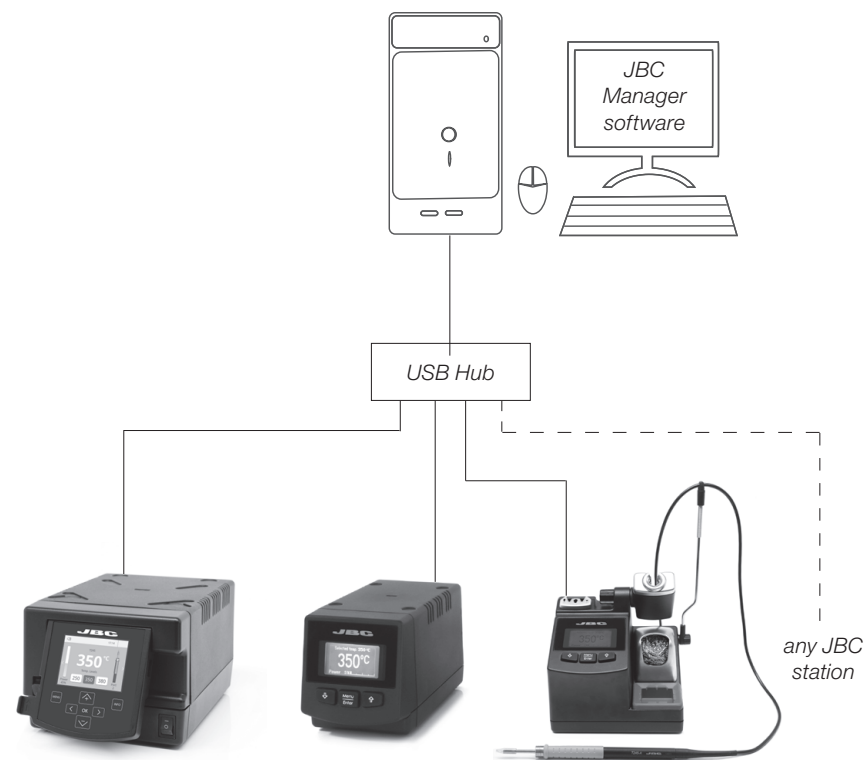

## Working with Robots

Manage and monitor the station using a Robotic system.

1. Connect the tool to the station port by means of the Converter.
2. Connect your Robot system to the Robot connector (RJ12) of the station.  
DB9-RJ12 Adapter available only if necessary (Ref: 0013772).
3. Enable the Robot option in the station settings and the notification will be displayed: 
4. Set your Robot's commands according to the Robot Communication Protocol, available on the website [www.jbctools.com/jbcsoftware-menu-115.html](http://www.jbctools.com/jbcsoftware-menu-115.html).

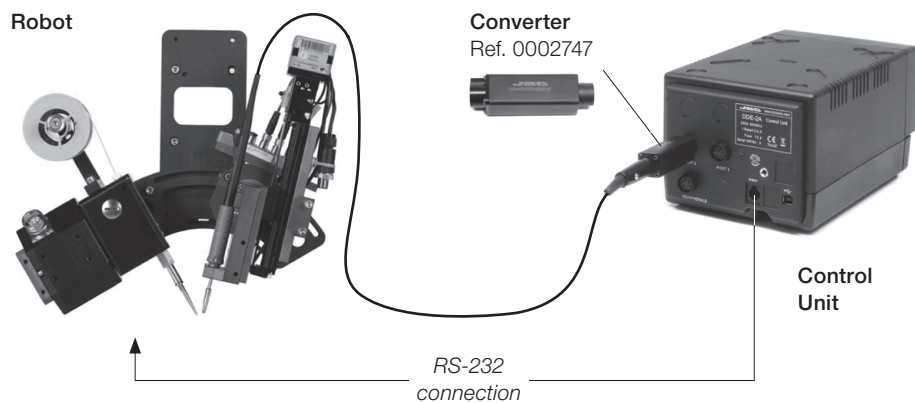

## Update the station software

1. Download the JBC Updater software from [www.jbctools.com/software.html](http://www.jbctools.com/software.html) and save it on a USB flash drive. Preferably one with no other files.

2. Insert the USB flash drive.  
The icon  is displayed while updating.

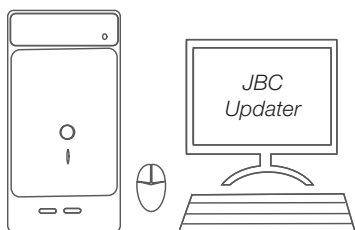

## Maintenance

Before carrying out maintenance or storage, always allow the equipment to cool.

- Clean the station screen with a glass cleaner or a damp cloth.
- Use a damp cloth to clean the casing and the tool. Alcohol can only be used to clean the metal parts.
- Periodically check that the metal parts of the tool and stand are clean so that the station can detect the tool status.
- Maintain tip surface clean and tinned prior to storage in order to avoid tip oxidation. Rusty and dirty surfaces reduce heat transfer to the solder joint.
- Periodically check all cables and tubes.
- Replace a blown fuse as follows:



Clean periodically

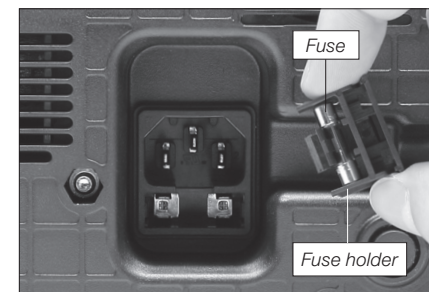
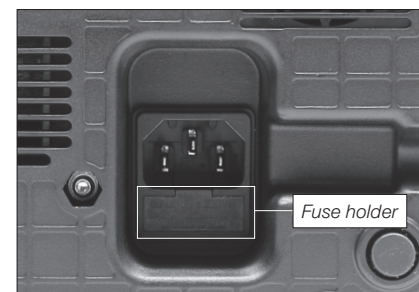
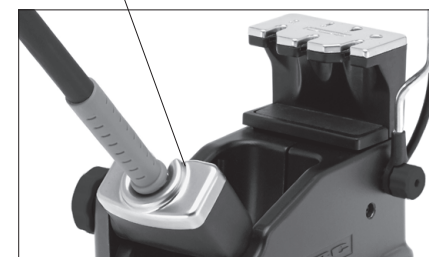

1. Pull off the fuse holder and remove the fuse. If necessary use a tool to lever it off.

2. Press the new fuse into the fuse holder and replace it in the station.

- Replace any defective or damaged pieces. Use original JBC spare parts only.
- Repairs should only be performed by a JBC authorized technical service.



## Safety



**It is imperative to follow safety guidelines to prevent electric shock, injury, fire or explosion.**

- Do not use the units for any purpose other than soldering or rework. Incorrect use may cause fire.
- The power cord must be plugged into approved bases. Be sure that it is properly grounded before use. When unplugging it, hold the plug, not the wire.
- Do not work on electrically live parts.
- The tool should be placed in the stand when not in use in order to activate the sleep mode. The soldering tip, the metal part of the tool and the stand may still be hot even when the station is turned off. Handle with care, including when adjusting the stand position.
- Do not leave the appliance unattended when it is on.
- Do not cover the ventilation grills. Heat can cause inflammable products to ignite.
- Use a "non residue" classified flux and avoid contact with skin or eyes to prevent irritation.
- Be careful with the fumes produced when soldering.
- Keep your workplace clean and tidy. Wear appropriate protective glasses and gloves when working to avoid personal harm.
- Utmost care must be taken with liquid tin waste which can cause burns.
- This appliance can be used by children over the age of eight and also persons with reduced physical, sensory or mental capabilities or lack of experience provided that they have been given adequate supervision or instruction concerning use of the appliance and understand the hazards involved. Children must not play with the appliance.
- Maintenance must not be carried out by children unless supervised.

## Specifications

### Complete Rework station with Pneumatic Pump

#### RMVE-1A / RMVE-2A / RMVE-9A

- Total weight: 16.6 kg (36.6 lb)
- Ambient Operating Temperature: 10 to 40°C (50 to 104°F)

**JT-1B** 120V 50/60Hz. Input fuse 8A

**JT-2B** 230V 50/60Hz. Input fuse 4A

**JT-9B** 100V 50/60Hz. Input fuse 8A

- Weight: 5.7 kg (12.6 lb)
- Dimensions: 148 x 184 x 140
- Output Peak Power: 1000W
- Temperature range: Room temperature / 150°C to 450°C (300°F to 840°F)  
Cool mode: T Off. Used to blow air at room temperature.
- Air flow regulation: 6-45 SLPM
- Vacuum: 30% / 228 mmHg / 9 inHg
- USB interface station-PC
- P-005 Pedal connection

**DDE-1A** 120V 50/60Hz. Input fuse: 4A. Output: 23.5V

**DDE-2A** 230V 50/60Hz. Input fuse: 2A. Output: 23.5V

**DDE-9A** 100V 50/60Hz. Input fuse: 5A. Output: 23.5V

- Weight: 4.3 Kg (9.3 lb)
- Dimensions: 148 x 120 x 232 mm
- Output Peak Power: 150W per tool
- Temperature Range: 90-450°C (190-840 °F)
- Idle Temp. Stability (still air)  $\pm 1.5$  °C ( $\pm 3$  °F)
- Tip to ground resistance: <2 ohms
- Tip to ground voltage: <2mV RMS
- USB-A / USB-B / Peripherals connectors
- RJ12 connector for Robot

#### MVE-A

- Weight: 0.9 Kg (1.9 lb)
- Dimensions: 145 x 55 x 225 mm
- Air Pressure supply range: 4-6 Bar
- Vacuum at 6 Bar: 90% / 680 mmHg / 26.8 inHg
- Flow rate: 15 SLPM

Complies with CE standards

ESD protected housing "skin effect"

# Exploded View

**RMVE-1A 120V**  
**RMVE-2A 230V**  
**RMVE-9A 100V**  
COMPLETE REWORK STATION  
WITH PNEUMATIC PUMP

SPARE PARTS		SPARE PARTS	
<b>DDE-1A / DDE-2A / DDE-9A:</b>			
-REAR CIRCUIT	0014997		
-ENCLOSURE			
- TOP	0011035		
- BOTTOM	0014567		
- FRONT+DISPLAY	0014612		
- BACK	0013413		
<b>MVE-A:</b>			
-CIRCUIT	0014059		
-ENCLOSURE			
- TOP	0014860		
- BOTTOM	0014861		
- FRONT	0014688		
- BACK	0014862		
-SOLENOID VALVE	0006813		
<b>JT-1B / JT-2B / JT-9B:</b>			
-ENCLOSURE		0011035	
- TOP		0009772	
- BOTTOM		0010064	
- FRONT		0012672	
- BACK			
<b>JT-2B:</b>			
-CIRCUIT	0013983		
-SUCTION PUMP	0008722		
-HOT AIR PUMP	0012273		
<b>JT-1B / JT-9B:</b>			
-CIRCUIT	0013981		
-SUCTION PUMP	0008723		
-HOT AIR PUMP	0012272		

DDE-1A 120V FUSE T-4A  
DDE-2A 230V FUSE T-2A  
DDE-9A 100V FUSE T-5A

JT-1B 120V FUSE T-8A  
JT-2B 230V FUSE T-4A  
JT-9B 100V FUSE T-8A

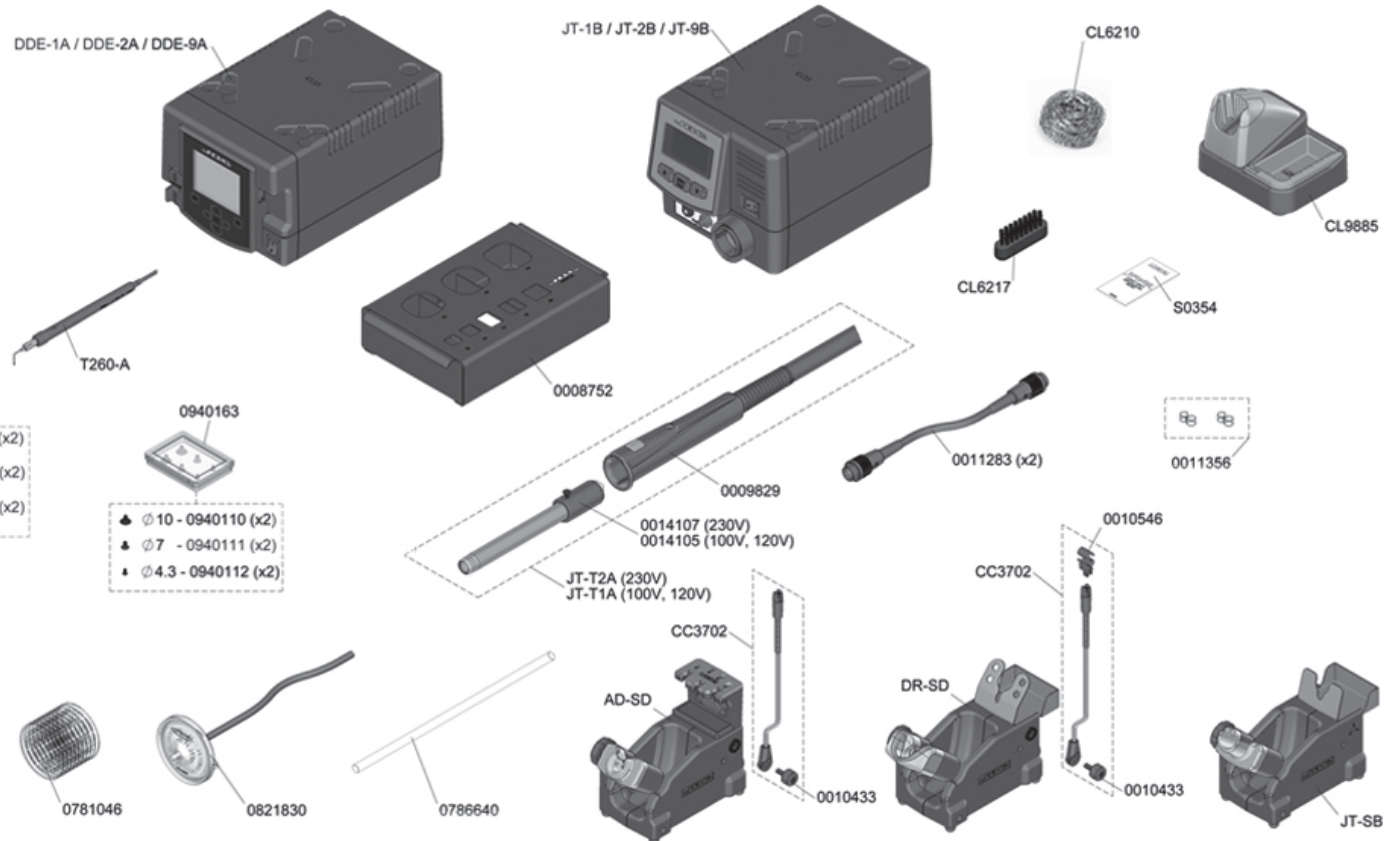
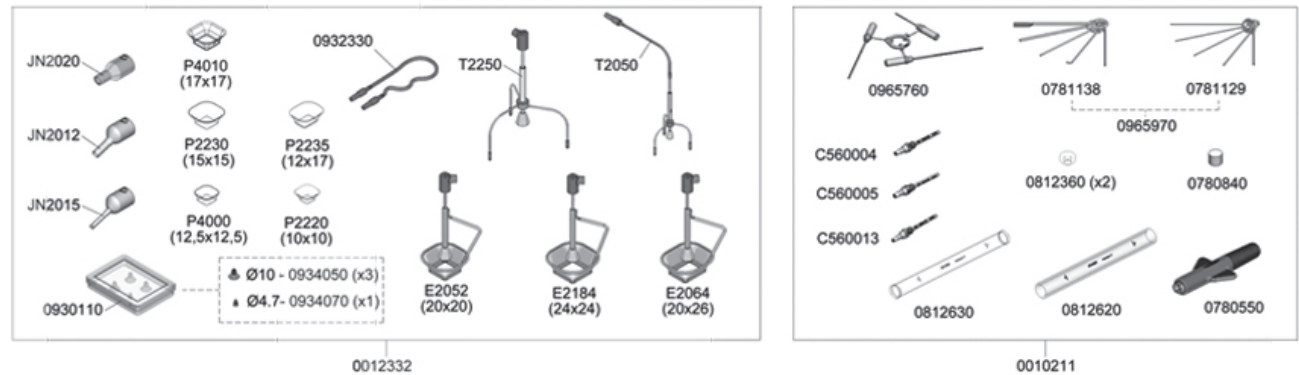

# JBC

---

## Warranty

JBC's 2 year warranty covers this equipment against all manufacturing defects, including the replacement of defective parts and labour. Warranty does not cover product wear due to use or mis-use.

In order for the warranty to be valid, equipment must be returned, postage paid, to the dealer where it was purchased.

---



This product should not be thrown in the garbage. In accordance with the European directive 2002/96/EC, electronic equipment at the end of their life must be collected and returned to an authorized recycling facility.