

JBC

www.jbctools.com

INSTRUCTION MANUAL



WS

High-Temperature Wire Stripper
Control Unit

This manual corresponds to the following references:

WS-9UA (100V)

WS-1UA (120V)

WS-2UA (230V)

Packing List

The following items are included:



High-Temperature Wire Stripper Control Unit 1 unit



Power Cord 1 unit
Ref. 0024092 (100V)
0023715 (120V)
0023714 (230V)



Manual 1 unit
Ref. 0030997

Features

WS Control Unit



Connections with WSST - WS140

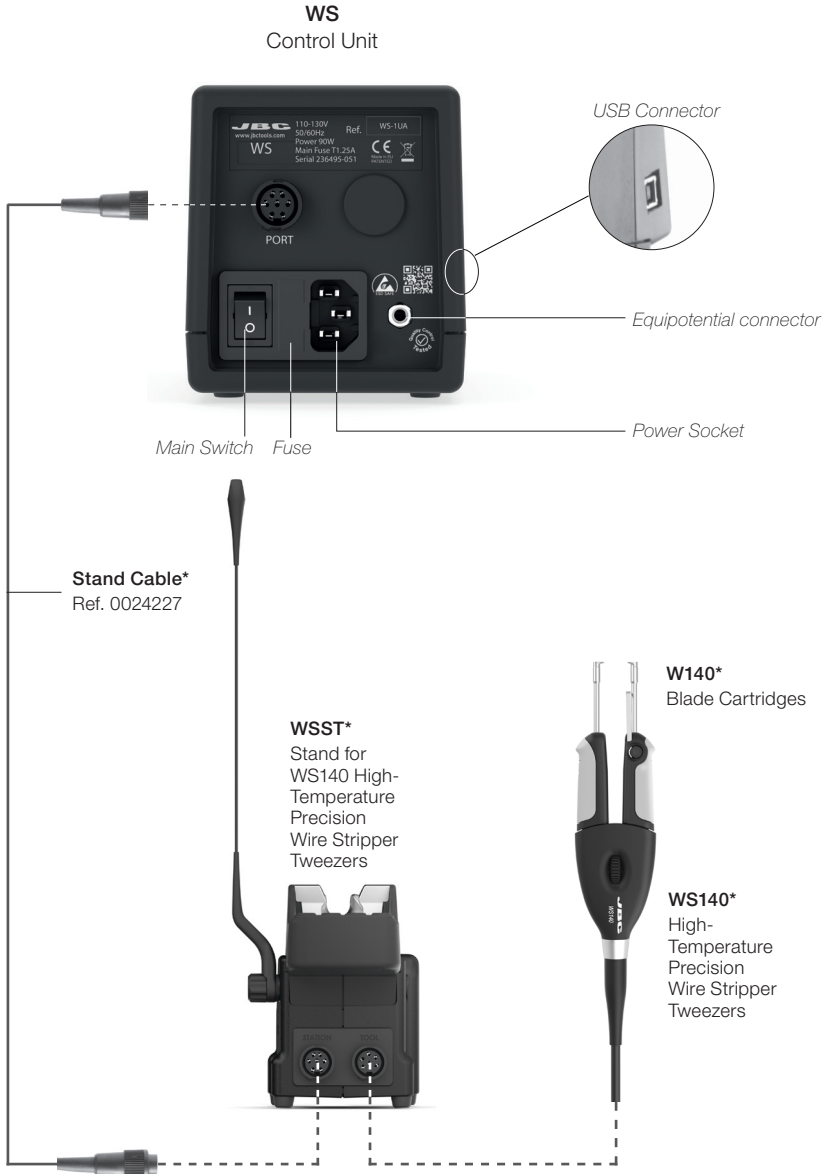

* not included, sold separately

Connections with WSBT - WS440

WS Control Unit

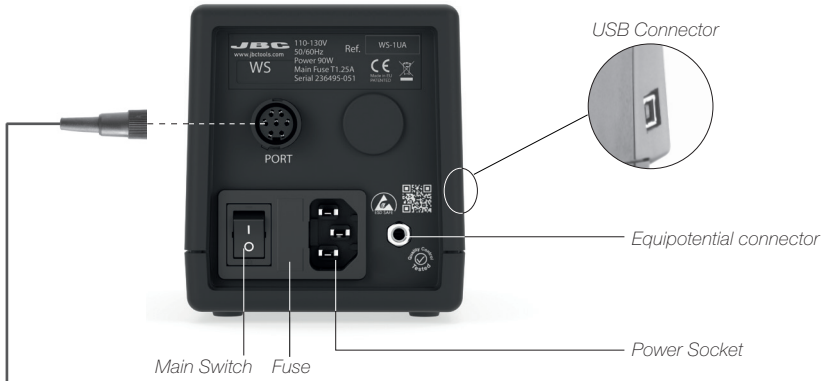

Stand Cable*
Ref. 0024227

WSBT*
Stand for
WS440 High-
Temperature
Wire Stripper
Tweezers



W440*
Blade Cartridges



WS440*
High-
Temperature
Wire Stripper
Tweezers

* not included, sold separately

Control Process

Work Screen

By default the “power level” is displayed at the work screen (1). It displays the power percentage.

It can be chosen to display the “temperature level” (2) in place of the power level. To do so follow the description below on the topics **Power and Temperature Levels**.

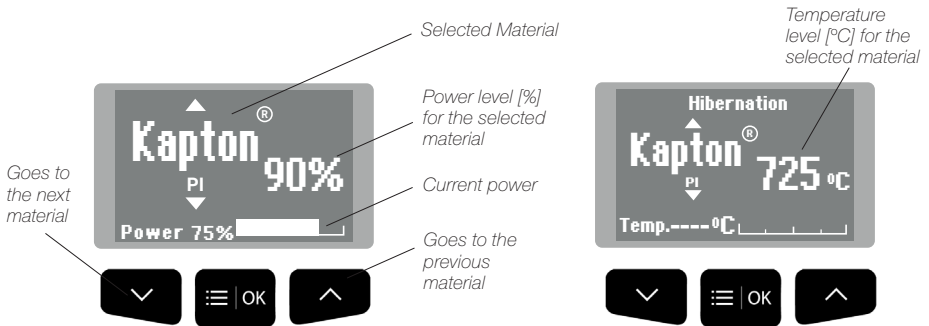

Menu Display

Default PIN: 0105

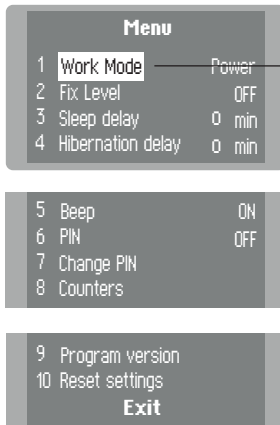

Power and Temperature Levels

Press to enter main menu, select Work Mode and press again. By default the Display shows “Power Mode” (1)

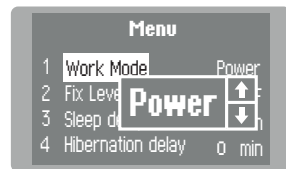

Press or to switch from Power Mode to “Temperature Mode” (2).

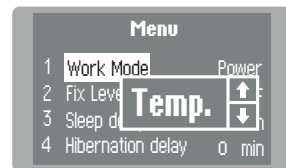

Work Modes

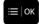

WS offers two different working modes. It can be chosen between predefined values for different materials and a customizable value by pressing short time .



Predefined Values

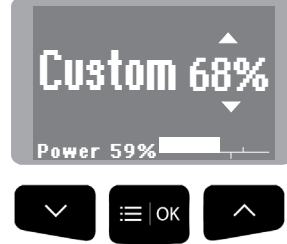

Customizable Value

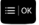

To choose from the material options the desired material, press the button  or  to scroll the menu up and down.

To work with customized values, press  and then the button  or  to select the power or temperature value.

Predefined Materials to Choose From

	Insulation Material	Symbol	Power Levels	Temp. Levels
Thermoplastics	Polyvinyl Chloride	PVC	6%	150 °C
	Polyethylene	PE	7%	175 °C
	Nylon ¹	PA	10%	235 °C
	Kynar ²	PVDF	16%	335 °C
	Tefzel ¹	ETFE	17%	345 °C
Thermostable	Teflon ¹	FEP	16%	335 °C
		PFA	21%	385 °C
		PTFE	40%	515 °C
	Ethylene Propylene Rubber	EPM/EPR	44%	535 °C
	Silicone Rubber	SI	51%	565 °C
Kapton ¹	PI	90%	725 °C	

¹ Registered Trade Marks of DuPont

² Registered Trade Marks of Arkema

Operation

Depending on where the tool is located, the soldering station switches between three different states: Work, Sleep and Hibernation.

1. Work

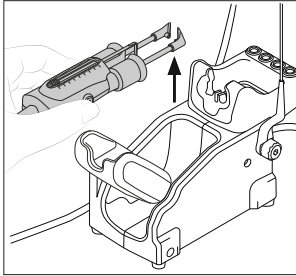

When the wire stripper is lifted from the stand, the cartridges will heat up according to the selected configuration.

2. Sleep

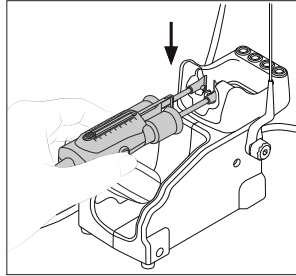

When the wire stripper is in the stand, the power falls after a specified time.

3. Hibernation

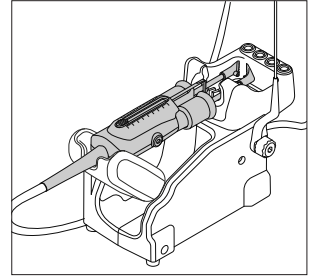

After longer periods of inactivity, the power is cut off and the cartridges cool down to room temperature.

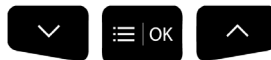

Troubleshooting

Station troubleshooting available on the product page at www.jbctools.com

Accessories

Pedal P305

It can be used to activate/deactivate the Wire Stripper. Sleep and hibernation delay has to be set to 0 min.

Lift the wire stripper from the stand, press and hold the pedal to activate them and strip the wire. Once the pedal is released the wire stripper enters in Hibernation. To reverse the pedal functionality flip the switch of the connection box.

Default PIN: 0105.

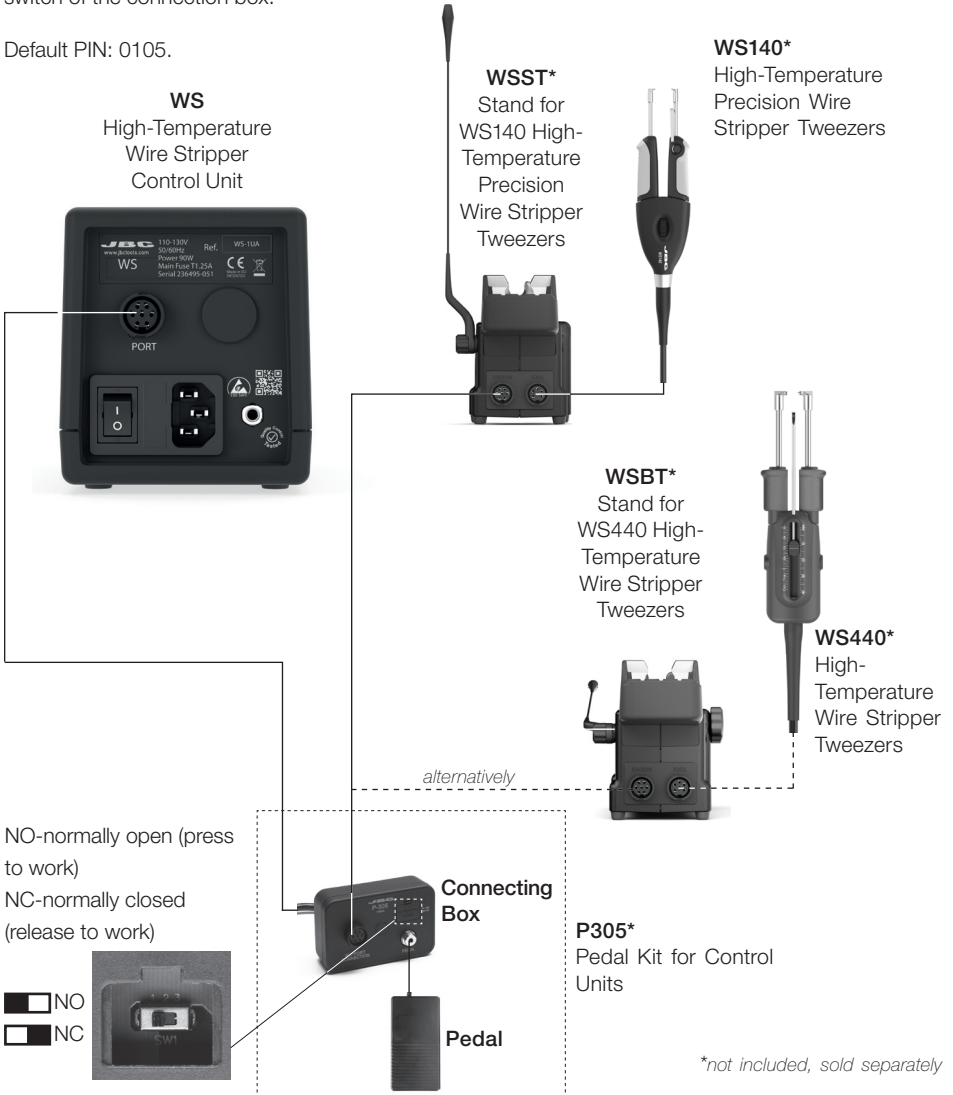

Accessories

Flat Screw Driver

To loosen or tighten the wire stripper screws use JBC Flat Screwdriver (Ref. 0023511).



Cartridge Extractor Pliers

To manipulate the cartridges use JBC's Cartridge Extractor Pliers (Ref. PLR195). More Information at www.jbctools.com



Removing

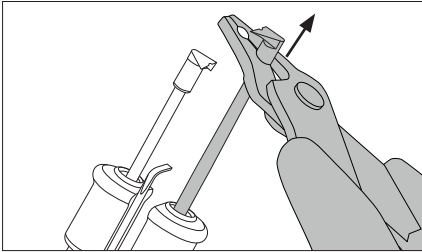

Remove cartridges with JBC's Cartridge Extractor Pliers (Ref. PLR195).

Inserting and Positioning

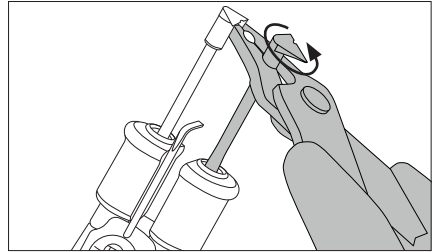

Align cartridges with JBC's pliers.

Metal Brush

For cleaning the tips if unwanted material gets stuck in use JBC's Metal Brush (Ref. 0022793).



Maintenance

Before carrying out maintenance or storage, always allow the equipment to cool and unplug the stand from the station and the tool.

- Clean the station screen with a glass cleaner or a damp cloth.
- Use a damp cloth to clean the casing, the stand and the tool. Alcohol can only be used for cleaning the metal parts.
- Periodically check that the metal parts of the tool and stand are clean so that the station can detect the tool status.
- Maintain tip surface clean in order to ensure a correct stripped wire.
- Periodically check all cables.
- Replace a blown fuse as follows (see specification chart) :



1. Take out the fuse holder and remove the fuse. If necessary use a tool to lever it out.

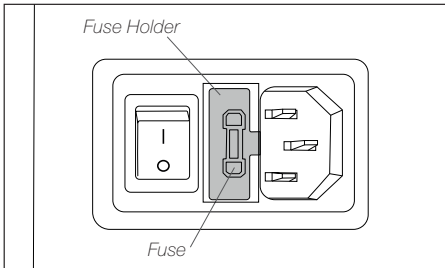

2. Press the new fuse into the fuse holder and reinsert it in the station.

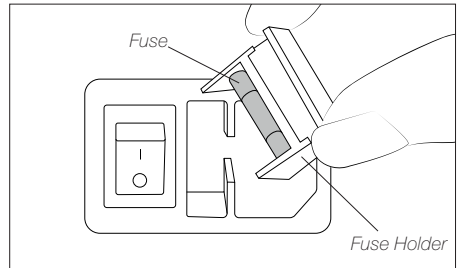

- Replace any defective or damaged pieces. Use original JBC spare parts only.
- Repairs should only be performed by a JBC authorized technical service.

Safety



It is imperative to follow safety guidelines to prevent electric shock, injury, fire or explosion.

Warning

- Do not touch the blade or the metal parts around.
- Do not allow the blade be close to flammable materials.
- Keep your workplace clean and tidy. Wear appropriate protection glasses and gloves when working to avoid personal harm.
- This appliance can be used by children over the age of eight and also persons with reduced physical, sensory or mental capabilities or lack of experience provided that they have been given adequate supervision or instruction concerning use of the appliance and understand the hazards involved.
- Maintenance must not be carried out by children unless supervised.
- Place the tool on the stand when is not in use.
- Turn off the power when not in use, changing parts or storing.

Caution

- Do not use the Wire Stripper for other applications than wire stripping.
- Do not modify or customize the Wire Stripper.
- Do not hit the blade against workbench to eliminate stripped insulation debris. This behavior would damage the blade.
- Remove power from the tool by holding the plug, not the wires.
- Be careful with the fumes produced when stripping. We recomend to use our fume extractor.

Specifications

WS

High-Temperature Wire Stripper Control Unit

Ref.: **WS-9UA** 100V 50/60Hz. Input Fuse: T1.6A. 5x20mm Output: 15V

Ref.: **WS-1UA** 120V 50/60Hz. Input Fuse: T1.25A. 5x20mm Output: 15V.

Ref.: **WS-2UA** 230V 50/60Hz. Input Fuse: T0.63A. 5x20mm Output: 15V.

- | | |
|---|--|
| - Temperature Max.: | 800 °C /1472 °F |
| - Power: | 75W |
| - Ambient Operating Temp.: | 10 to 50 °C /50 to 120 °F |
| - Connections: | USB-B |
| - Control Unit Dimensions:
(L x W x H) | 180 x 94 x 106 mm
7.1 x 3.7 x 4.2 in |
| - Total Net Weight: | 2.25 kg / 4.96 lb |
| - Total Package Dimensions / Weight:
(L x W x H) | 213 x 220 x 160 mm / 2.52 kg
8.39 x 8.66 x 6.30 in /5.57 lb |

Complies with CE standards.
ESD safe.

JBC

Warranty

JBC's 2 year warranty covers this equipment against all manufacturing defects, including the replacement of defective parts and labour.

Warranty does not cover product wear or misuse.

In order for the warranty to be valid, equipment must be returned, postage paid, to the dealer where it was purchased.

Get 1 extra year JBC warranty by registering here:
<https://www.jbctools.com/productregistration/>
within 30 days of purchase.



This product should not be thrown in the garbage.

In accordance with the European directive 2012/19/EU, electronic equipment at the end of its life must be collected and returned to an authorized recycling facility.

**CE EAC UK
CA**

www.jbctools.com

0030997-301023