

JBC

www.jbctools.com

INSTRUCTION MANUAL



GSF

Guide Kits for SF280

This manual corresponds to the following references:

With Solder Wire Perforation:

- GSF08V-B** for wire Ø 0.8 mm / Ø 0.032 in
- GSF10V-B** for wire Ø 1.0 mm / Ø 0.040 in
- GSF12V-B** for wire Ø 1.2 mm / Ø 0.047 in
- GSF15V-B** for wire Ø 1.5 mm / Ø 0.059 in
- GSF16V-B** for wire Ø 1.6 mm / Ø 0.063 in

Without Solder Wire Perforation:

- GSF04D-B** for wire Ø 0.38 - 0.40 mm / Ø 0.015 - 0.016 in
- GSF05D-B** for wire Ø 0.46 - 0.56 mm / Ø 0.018 - 0.022 in
- GSF06D-B** for wire Ø 0.60 - 0.64 mm / Ø 0.023 - 0.025 in
- GSF07D-B** for wire Ø 0.70 - 0.78 mm / Ø 0.028 - 0.031 in
- GSF08D-B** for wire Ø 0.80 - 0.82 mm / Ø 0.032 - 0.033 in
- GSF10D-B** for wire Ø 0.90 - 1.10 mm / Ø 0.036 - 0.044 in
- GSF12D-B** for wire Ø 1.14 - 1.27 mm / Ø 0.045 - 0.051 in
- GSF15D-B** for wire Ø 1.50 - 1.57 mm / Ø 0.060 - 0.062 in
- GSF16D-B** for wire Ø 1.60 - 1.63 mm / Ø 0.063 - 0.065 in
- GSF18D-B** for wire Ø 1.80 mm / Ø 0.073 in

GSF Guide Kit for SF280 with Solder Wire Perforation

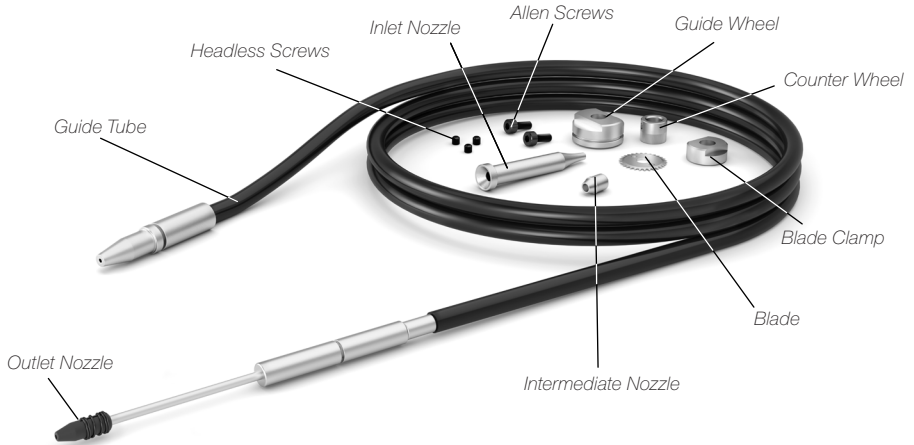

Packing List

The following items are included:

Guide Tube*	1 unit	Allen Screws*	2 units
Inlet Nozzle*	1 unit	Headless Screws*	3 units
Guide Wheel*	1 unit		
Counter Wheel*	1 unit		
Blade Clamp*	1 unit		
Blade*	1 unit		
Intermediate Nozzle*	1 unit		
Outlet Nozzle*	1 unit	Manual	1 unit

*references see table on page 4

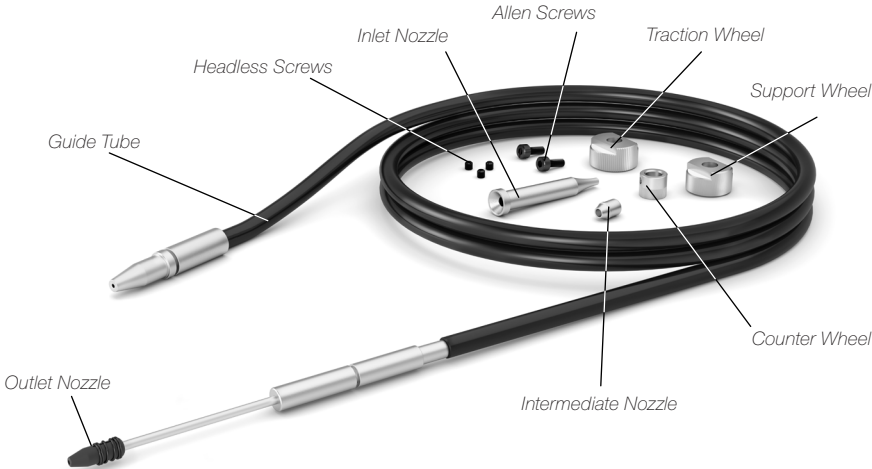

Ref. 0028099

GSF Guide Kit for SF280 without Solder Wire Perforation**Packing List**

The following items are included:

Guide Tube*	1 unit	Allen Screws*	2 units
Inlet Nozzle*	1 unit	Headless Screws*	3 units
Traction Wheel*	1 unit		
Support Wheel*	1 unit		
Counter Wheel*	1 unit		
Intermediate Nozzle*	1 unit		
Outlet Nozzle*	1 unit	Manual	1 unit



*references see table on page 5

Ref. 0028099

GSF Guide Kit for SF280 with Solder Wire Perforation

GSFXXV-B WITH SOLDER WIRE PERFORATION

XX	Wire diameter
08	Ø0.8 mm Ø0.032 in
10	Ø1.0 mm Ø0.040 in
12	Ø1.2 mm Ø0.047 in
15	Ø1.5 mm Ø0.059 in
16	Ø1.6 mm Ø0.063 in

Guide tube
GSF08X-B 0018630
GSF10X-B 0019168
GSF12X-B 0026113
GSF15X-B 0019169
GSF16X-B 0026115

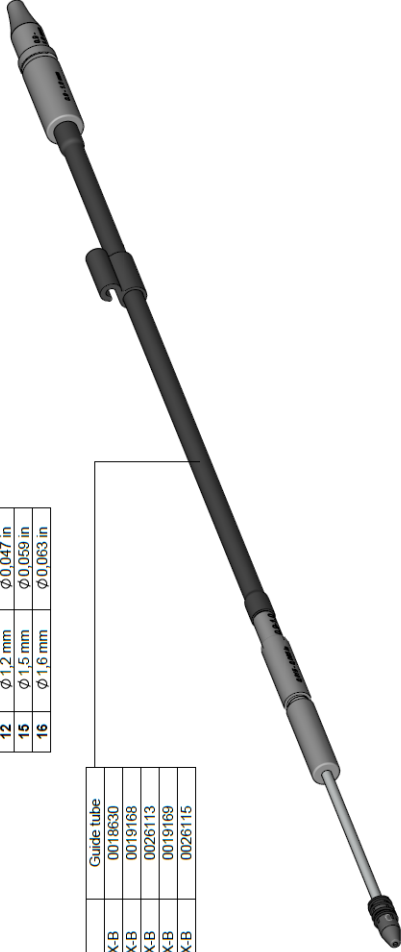

SPARE PARTS

Wire Ø	Outlet nozzle	Nozzle	Guide wheel	Blade	Blade clamp	Inlet nozzle	Interm. nozzle	Counter wheel	Screws	Threaded stud
GSF08V-B	0025270	0030913	0021696 0021699 0023738 0019686 0025922	0021555	0018638	0018632 0019170 0019171 0024233	0024955 0024956 0024957 0024958 0024959	0026893 0026894	0026895 (x2)	0026896 (x3)
GSF10V-B	0021560									
GSF12V-B	0025272									
GSF15V-B	0025274									
GSF16V-B	0025276									

GSF Guide Kit for SF280 without Solder Wire Perforation

GSFXXD-B WITHOUT SOLDER WIRE PERFORATION

XX	Wire diameter
	Range of use
04	Ø 0.38 - 0.40 mm Ø 0.015 - 0.016 in
05	Ø 0.46 - 0.56 mm Ø 0.018 - 0.022 in
06	Ø 0.60 - 0.64 mm Ø 0.023 - 0.025 in
07	Ø 0.70 - 0.78 mm Ø 0.028 - 0.031 in
08	Ø 0.80 - 0.82 mm Ø 0.032 - 0.033 in
10	Ø 0.90 - 1.10 mm Ø 0.036 - 0.044 in
12	Ø 1.14 - 1.27 mm Ø 0.045 - 0.051 in
15	Ø 1.50 - 1.57 mm Ø 0.060 - 0.063 in
16	Ø 1.60 - 1.63 mm Ø 0.063 - 0.065 in
18	Ø 1.80 mm Ø 0.073 in

Guide tube
GSF04X-B
GSF05X-B
GSF06X-B
GSF07X-B
GSF08X-B
GSF10X-B
GSF12X-B
GSF15X-B
GSF16X-B
GSF18X-B

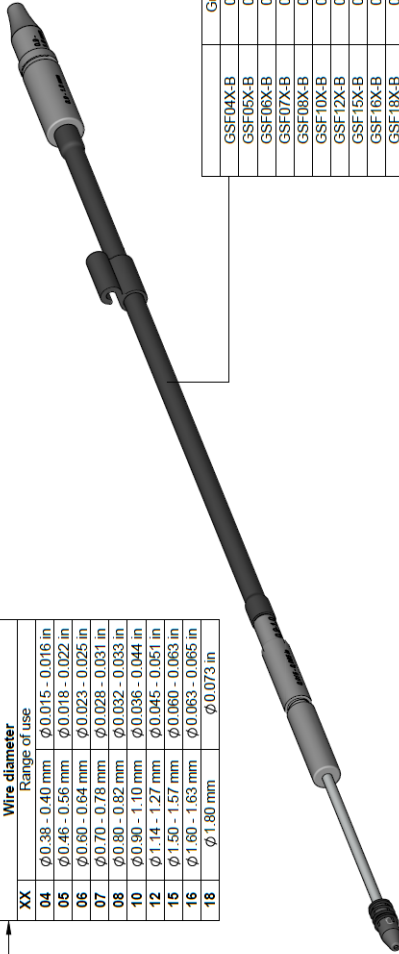

SPARE PARTS

Wire Ø	Outlet nozzle	Nozzle	Traction wheel	Support wheel	Inlet nozzle	Interm. nozzle	Counter wheel	Screws	Threaded stud
GSF04D-B	0022512	0030913	0019479	0020345	0019520	0024964	0022683	0022686 (A2)	0022686 (A3)
GSF05D-B	0025268			0019519					
GSF06D-B	0022994								
GSF07D-B	0025289			0019480	0019632	0025293			
GSF08D-B	0025270				0019170	0024955			
GSF10D-B	0021560			0019481	0019171	0024967			
GSF12D-B	0025272				0024959	0024959			
GSF15D-B	0025274			0022423	0024233	0024968			
GSF16D-B	0025276			0022637	0024234	0024960			
GSF18D-B	0021559								

Changing Guide Kits

Changing Wheels and Blade

For this operation, disconnect the device from the mains. Disconnect the tool from the control unit and open its cover.

Use the Allen key and the spanner, provided with the station. First disassemble the guide tube (6), the support and traction wheels, or the guide wheel, the blade and its clamp (4)+(5). Then, disassemble the nozzles (2)+(3). Disassemble the counter wheel (1) if needed*.

Assembly with Solder Wire Perforation:

Assemble the counter wheel (1) if needed*.

Insert the intermediate nozzle (2) until its collar rests against the housing and tighten the screw.

Assemble the inlet nozzle (3).

Assemble the guide wheel** (4) and tighten the screw.

Assemble the blade first, then mount the blade clamp (5) onto the same axis and tighten the screw.

Caution: handle the blade carefully to avoid injury.

Insert the guide set (6).

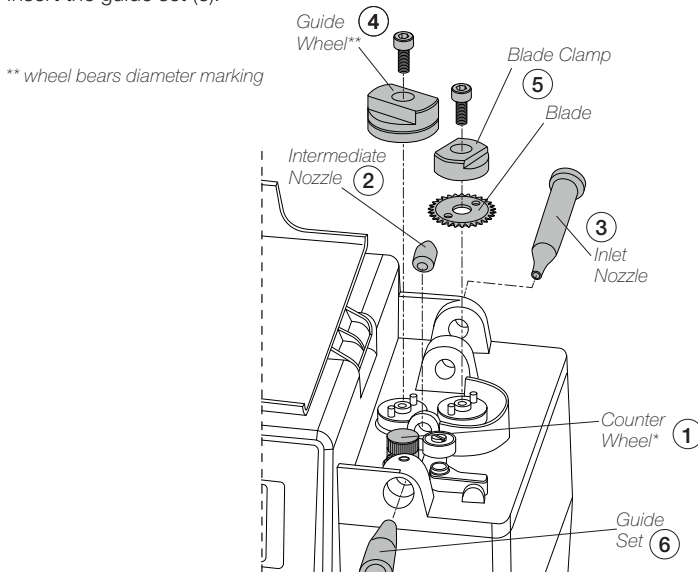

** wheel bears diameter marking

* SF comes with a counter wheel already assembled.

Only change the counter wheel if you want to work with a wire diameter that is outside the working range of the counter wheel already assembled to the SF.

Assembly without Solder Wire Perforation:

Assemble the counter wheel (1) if needed*.

Insert the intermediate nozzle (2) until its collar rests against the housing and tighten the screw.

Assemble the inlet nozzle (3).

Assemble the support wheel** (4) onto the axis and tighten the screw.

Assemble the traction wheel (5) and tighten the screw.

Insert the guide set (6).

** wheel bears diameter marking

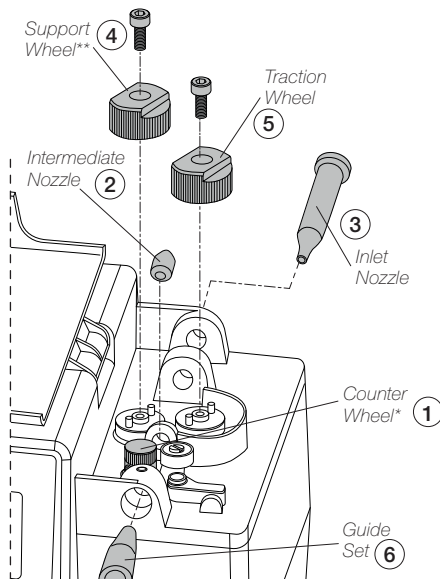

* SF comes with a counter wheel already assembled.

Only change the counter wheel if you want to work with a wire diameter that is outside the working range of the counter wheel already assembled to the SF.

Outlet Nozzle Replacement

Flux can cause clogging at the outlet nozzle of the guide tube set and it can be necessary to replace the worn or clogged outlet nozzle.

Note: There is a nozzle size for each soldering wire diameter. The use of the nozzle is necessary as its inner diameter is adjusted to the solder wire diameter and guides the wire with greater precision.

To replace the outlet nozzle, follow these steps:

First, unload any remaining solder wire that might still be inside the guide tube (see page 9) and then unplug the tool. Unscrew the spring inwards (2), following the downward direction of the spring.



Once the outlet nozzle is released from the spring, pull the outlet nozzle out (2) and then remove the spring (3).

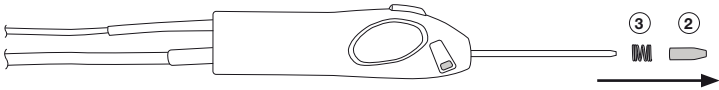

Place the new outlet nozzle onto the guide tube set (4) and then screw back the spring onto it to fix the outlet nozzle onto the guide tube (5).

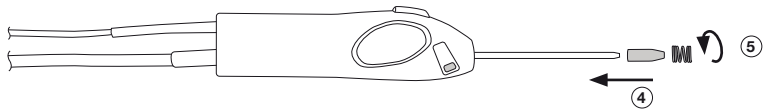

Guide Tube Replacement

To replace the guide tube, follow the outlet replacement steps until reaching no. 3. Once both the outlet nozzle and the spring are removed, open the guide clamp knob (6) and remove the guide tube (7).

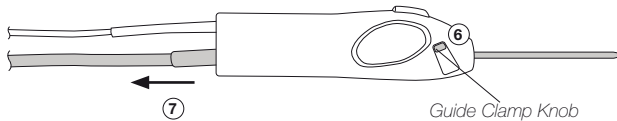

Insert the new guide tube into the tool, close the guide clamp knob to fix it in place and follow steps 4 and 5 to fix the outlet nozzle.

Enter "Tool Settings" at the SF control unit main menu and select the proper wire diameter to complete the process.

Main Menu

- 1 Reset settings
- 2 Station settings
- 3 Tool settings
- 4 Programs Settings

Tool Assembly

Connect the tool to the control unit following this steps:

Insert and push the guide nozzle until the end (1) and tighten the screw (2).

Connect the jack (3).

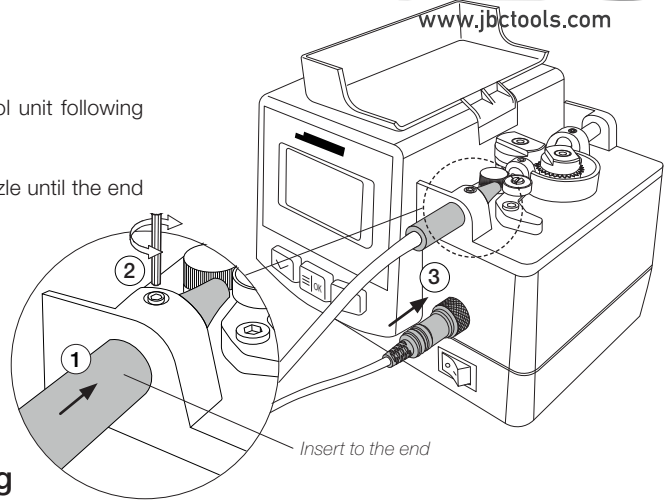



Solder Wire Loading

Put the solder reel into its support (1).

Introduce the solder wire into the inlet nozzle (2) until it reaches the wheels (3).

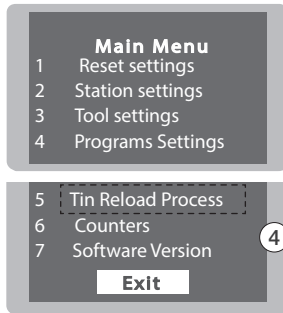
Use the *Tin Reload Process* in the *Main Menu* (4).



The Reload Process screen opens. Press  to start the process.

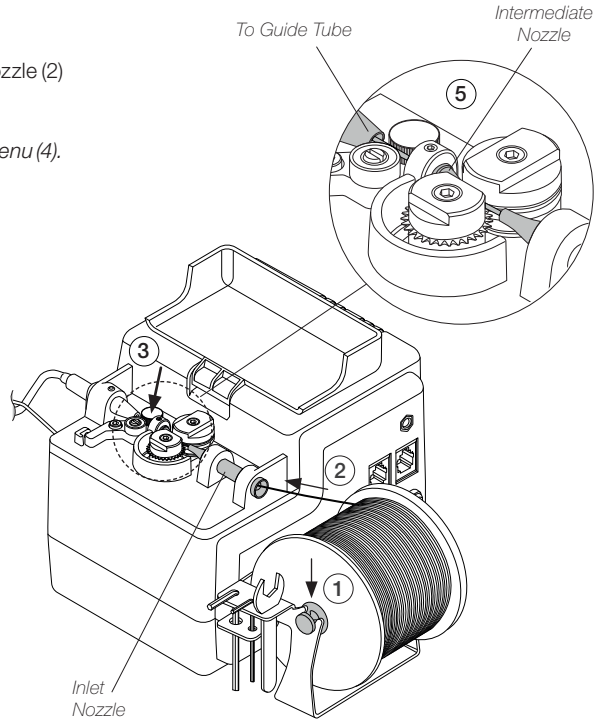
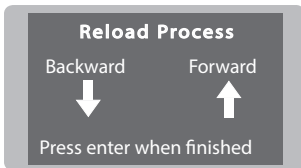

Make sure the wire passes through the Intermediate Nozzle and enters into the Guide Tube (5).

Solder-Wire Unloading

With Solder Wire Perforation

To unload solder wire with perforation that has already passed through the guide tube, cut the wire between the solder reel and the inlet nozzle (1).

To extract the wire out of the tube, hold the tool on your hand and press until the wire stops moving forward.

Grasp the wire coming out of the outlet nozzle with a pliers and pull from it until it is completely out.

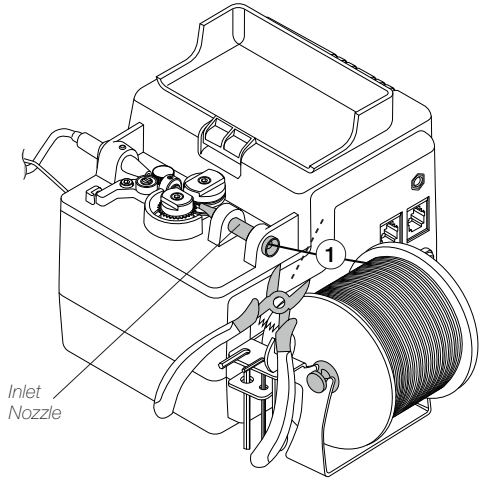

With Solder Wire Perforation

When using a guide kit without solder wire perforation, press until the wire is completely wound on the solder reel to unload the solder wire. It is best to rotate the reel by hand as the wire is being pulled back in order to keep it neatly arranged on the reel.

Or, if preferred, proceed as described before for perforated solder wire unloading.

Specifications

GSF

Guide Kits for SF280

With Perforation:

Ref.: **GSF08V-B** wire \varnothing 0.8 mm / \varnothing 0.032 in
 Ref.: **GSF10V-B** wire \varnothing 1.0 mm / \varnothing 0.040 in
 Ref.: **GSF12V-B** wire \varnothing 1.2 mm / \varnothing 0.047 in
 Ref.: **GSF15V-B** wire \varnothing 1.5 mm / \varnothing 0.059 in
 Ref.: **GSF16V-B** wire \varnothing 1.6 mm / \varnothing 0.063 in

	Total Net Weight:	Package Weight:
Ref.: GSF08V-B wire \varnothing 0.8 mm / \varnothing 0.032 in	108 g / 0.24 lb	200 g / 0.44 lb
Ref.: GSF10V-B wire \varnothing 1.0 mm / \varnothing 0.040 in	108 g / 0.24 lb	200 g / 0.44 lb
Ref.: GSF12V-B wire \varnothing 1.2 mm / \varnothing 0.047 in	94 g / 0.21 lb	186 g / 0.41 lb
Ref.: GSF15V-B wire \varnothing 1.5 mm / \varnothing 0.059 in	94 g / 0.21 lb	186 g / 0.41 lb
Ref.: GSF16V-B wire \varnothing 1.6 mm / \varnothing 0.063 in	94 g / 0.21 lb	186 g / 0.41 lb
Without Perforation:		
GSF04D-B for wire \varnothing 0.38 - 0.40 mm / \varnothing 0.015 - 0.016 in	104 g / 0.23 lb	196 g / 0.43 lb
GSF05D-B for wire \varnothing 0.46 - 0.56 mm / \varnothing 0.018 - 0.022 in	104 g / 0.23 lb	196 g / 0.43 lb
GSF06D-B for wire \varnothing 0.60 - 0.64 mm / \varnothing 0.023 - 0.025 in	104 g / 0.23 lb	196 g / 0.43 lb
GSF07D-B for wire \varnothing 0.70 - 0.78 mm / \varnothing 0.028 - 0.031 in	104 g / 0.23 lb	196 g / 0.43 lb
GSF08D-B for wire \varnothing 0.80 - 0.82 mm / \varnothing 0.032 - 0.033 in	104 g / 0.23 lb	196 g / 0.43 lb
GSF10D-B for wire \varnothing 0.90 - 1.10 mm / \varnothing 0.036 - 0.044 in	90 g / 0.20 lb	182 g / 0.40 lb
GSF12D-B for wire \varnothing 1.14 - 1.27 mm / \varnothing 0.045 - 0.051 in	90 g / 0.20 lb	182 g / 0.40 lb
GSF15D-B for wire \varnothing 1.50 - 1.57 mm / \varnothing 0.060 - 0.062 in	90 g / 0.20 lb	182 g / 0.40 lb
GSF16D-B for wire \varnothing 1.60 - 1.63 mm / \varnothing 0.063 - 0.065 in	90 g / 0.20 lb	182 g / 0.40 lb
GSF18D-B for wire \varnothing 1.80 mm / \varnothing 0.073 in	90 g / 0.20 lb	182 g / 0.40 lb
- Guide Tube Length:	126 cm / 49.6 in	
- Package Dimensions: (L x W x H)	245 x 185 x 45 mm 9.65 x 7.28 x 1.77 in	
Complies with CE standards. ESD safe		

JBC

Warranty

JBC's 2 year warranty covers this equipment against all manufacturing defects, including the replacement of defective parts and labour.

Warranty does not cover product wear or misuse.

In order for the warranty to be valid, equipment must be returned, postage paid, to the dealer where it was purchased.



This product should not be thrown in the garbage.

In accordance with the European directive 2012/19/EU, electronic equipment at the end of its life must be collected and returned to an authorized recycling facility.



www.jbctools.com

0028099-080124